

SAW Filter 119.64MHz

Model: TB0777A

Part No: MP02129

REV NO.: 1

A. MAXIMUM RATING:

1. Input Power Level: 10 dBm
2. DC voltage : 3 V
3. Operating Temperature: -40°C to +85°C
4. Storage Temperature: -40°C to +85°C

B. ELECTRICAL CHARACTERISTICS:

Item	Unit	Min.	Typ.	Max.	Note
Center frequency, Fc	MHz	-	119.64	-	-
Minimum Insertion Loss, IL	dB	-	4	5.5	-
3 dB bandwidth (from Fc)	KHz	5	55	-	-
Group delay ripple in Fc±2.5KHz, GD	µs	-	5	10	-
Attenuation:(Ref level from min IL)					
Fc - 2.5 to Fc + 2.5 KHz	dB	-	1.2	3.0	-
Fc ± 80 to Fc ± 120 KHz	dB	13	23	-	-
Fc ± 120 to Fc ± 240 KHz	dB	43	50	-	-
Fc ± 240 to Fc ± 330 KHz	dB	45	55	-	-
Fc ± 330 to Fc ± 480 KHz	dB	45	55	-	-
Fc ± 480 to Fc ± 660 KHz	dB	45	55	-	-
Temperature coefficient of frequency TCf		-0.033 ppm/C ²			

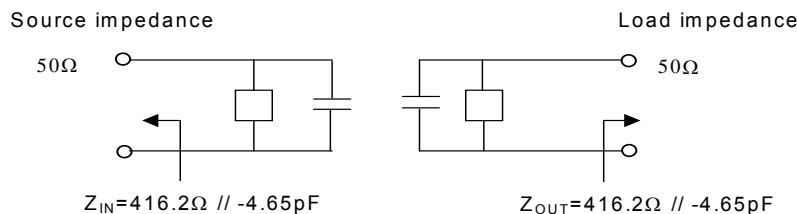

SAW Filter 119.64MHz

Model: TB0777A

Part No: MP02129

REV NO.: 1

C. OUTLINE DRAWING:

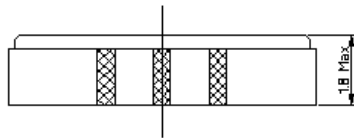
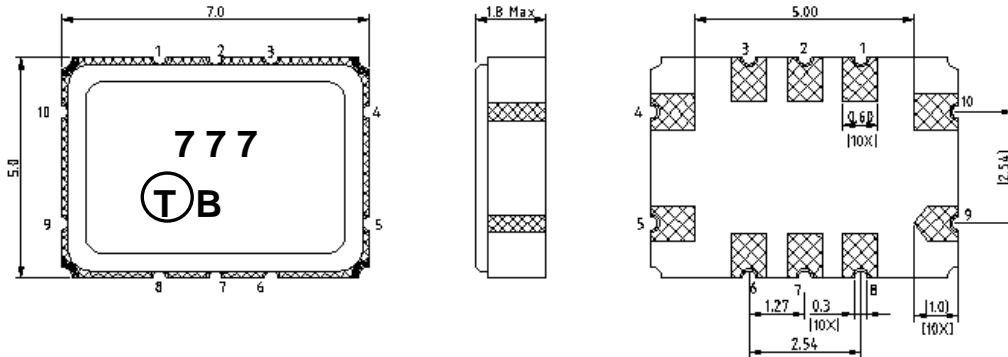

Pin configuration

- #9 Input
 - #4 Output
 - #10 Balance input or input ground
 - #5 Balance output or output ground
 - #1,2,3,6,7,8 To be grounded
- Unit mm

D. MEASUREMENT CIRCUIT:

50 Ohm Test circuit 1 (single-ended / single-ended)

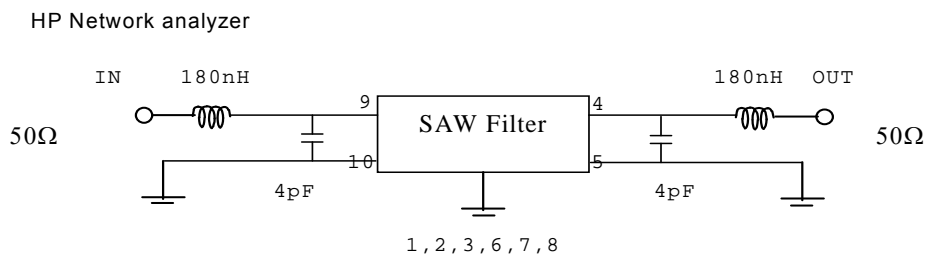

50 Ohm Test circuit 2 (balance / balance)

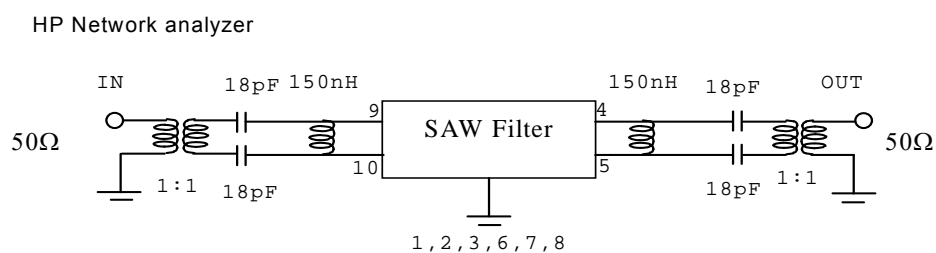

SAW Filter 119.64MHz
Part No: MP02129

Model: TB0777A
REV NO.: 1

E. FREQUENCY CHARACTERISTICS:

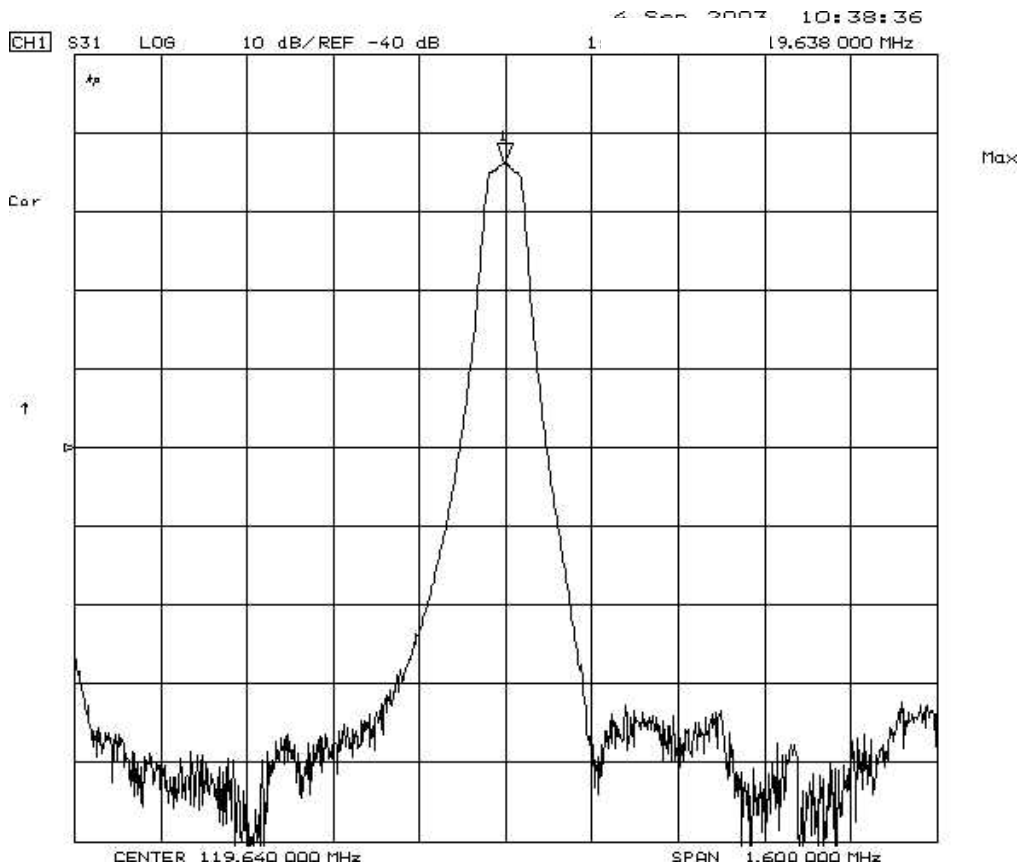
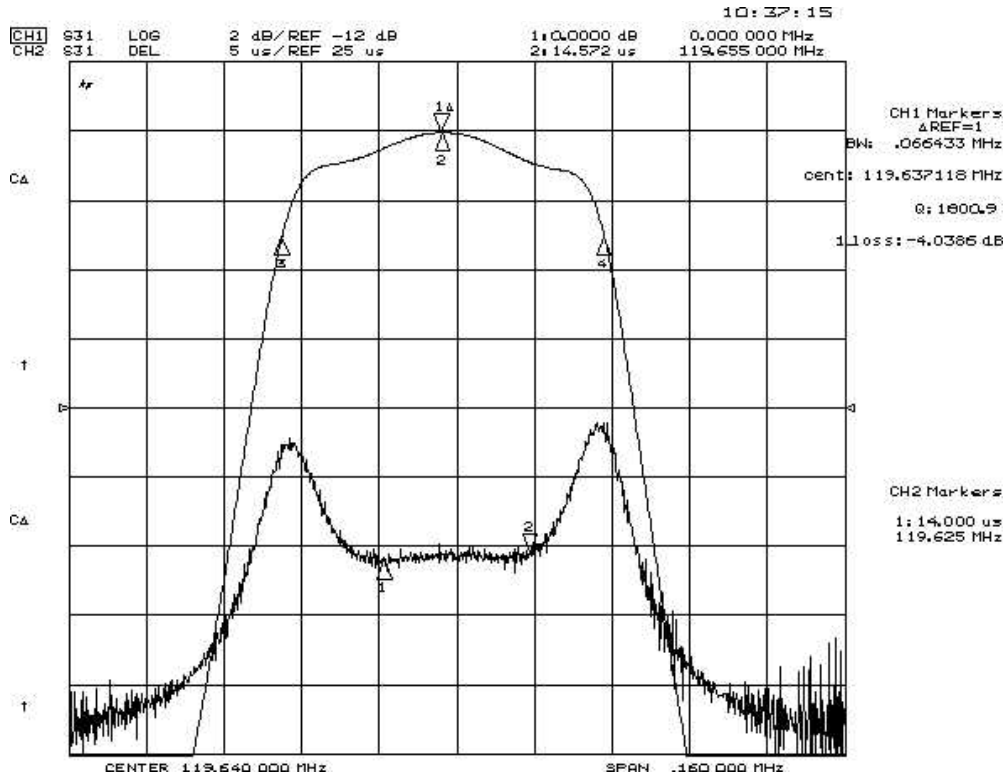

SAW Filter 119.64MHz

Model: TB0777A

Part No: MP02129

REV NO.: 1

F. PACKING:

1. REEL DIMENSION

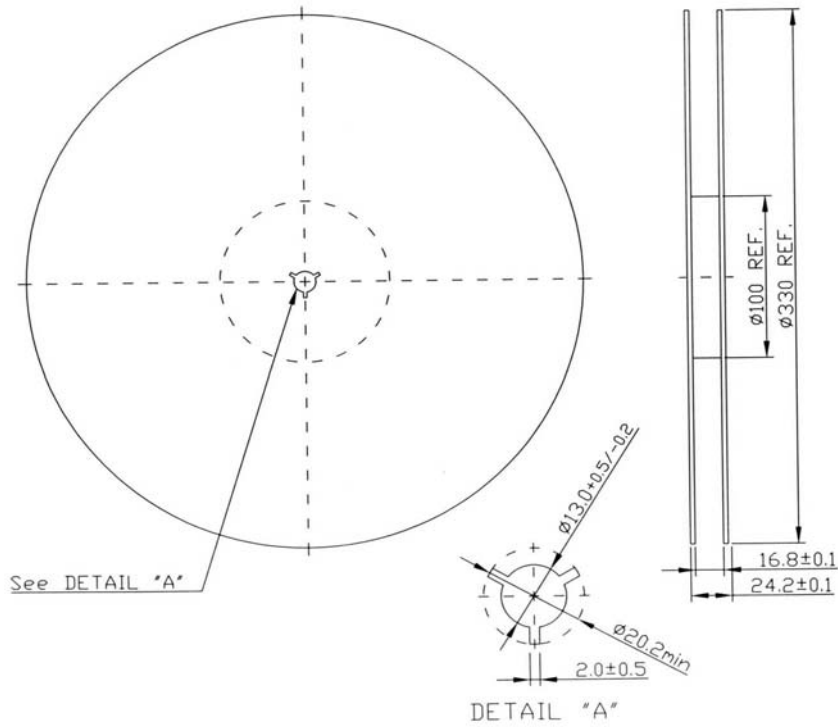

2. TAPE DIMENSION

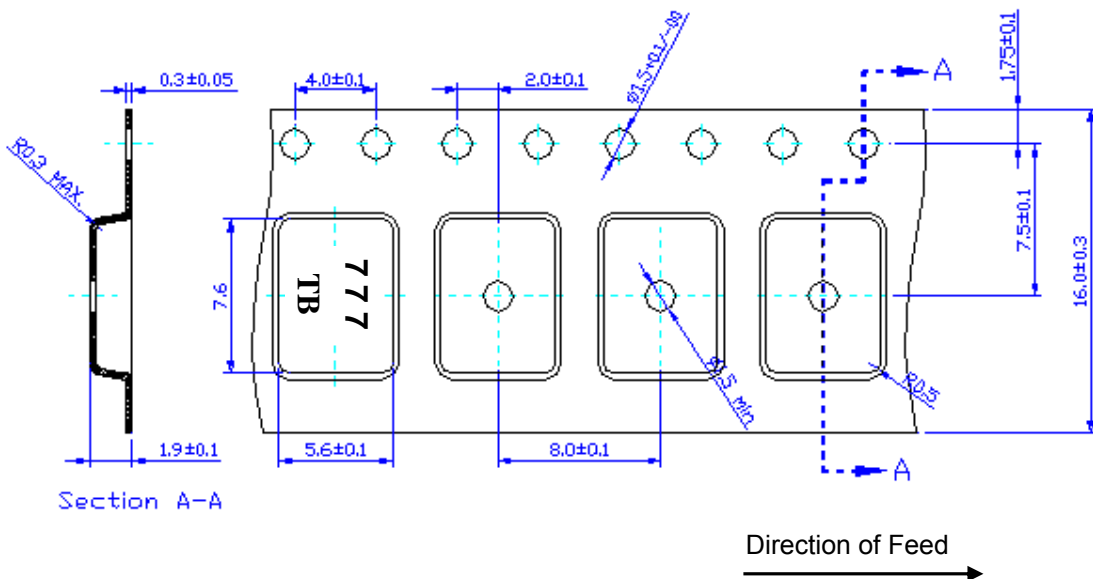

SAW Filter 119.64MHz

Model: TB0777A

Part No: MP02129

REV NO.: 1

G. RECOMMENDED REFLOW PROFILE :

