SAW Filter 70.0MHz

Model: TB0474A

Part No: MP01881

REV. NO.:1

A. MAXIMUM RATINGS:

1. Operating Temperature: -30°C to 60°C
2. Storage Temperature: -40°C to 85°C
3. Input Power: 10dBm

B. ELECTRICAL CHARACTERISTICS:

1. Ambient Temperature: 25°C

Item	Unit	Min.	Typ.	Max.
Center frequency, Fc	MHz	-	70	-
Insertion Loss, IL	dB	-	18.4	20
Upper -1dB frequency	MHz	87.5	87.7	-
Lower -1dB frequency	MHz	-	52.2	52.5
Upper -45dB frequency	MHz	-	92.7	94
Lower -45dB frequency	MHz	47	49.5	-
Ultimate rejection				
1MHz~45MHz	dB	40	47	
95MHz~120MHz	dB	35	41	
Passband Ripple				
52.5 – 87.5 MHz	dB	-	0.85	1.2
Absolute Group Time Delay	nsec	-	960	1000
Temperature Coefficient	ppm/°C	-	-72	-
Source Impedance (Balanced)	Ω	-	50	-
Load Impedance (Balanced)	Ω	-	50	-

SAW Filter 70.0MHz
Part No: MP01881

Model: TB0474A
REV. NO.:1

C. FREQUENCY CHARACTERISTICS:

(1) Wide band Response:(span 100MHz)

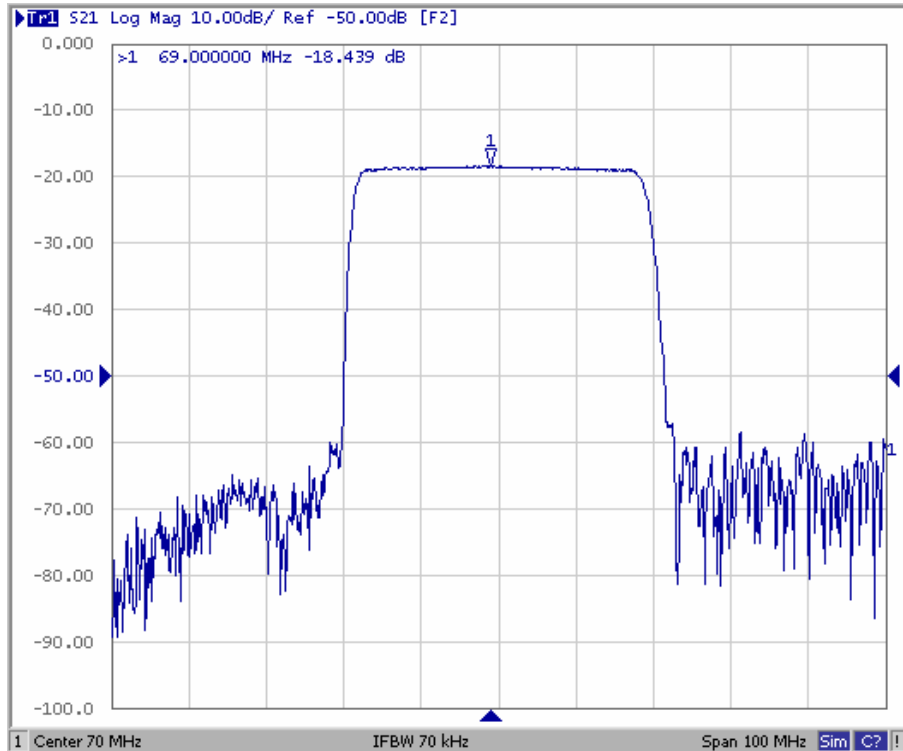

(2) Pass band Response and Group Time Delay response:(span 50MHz)

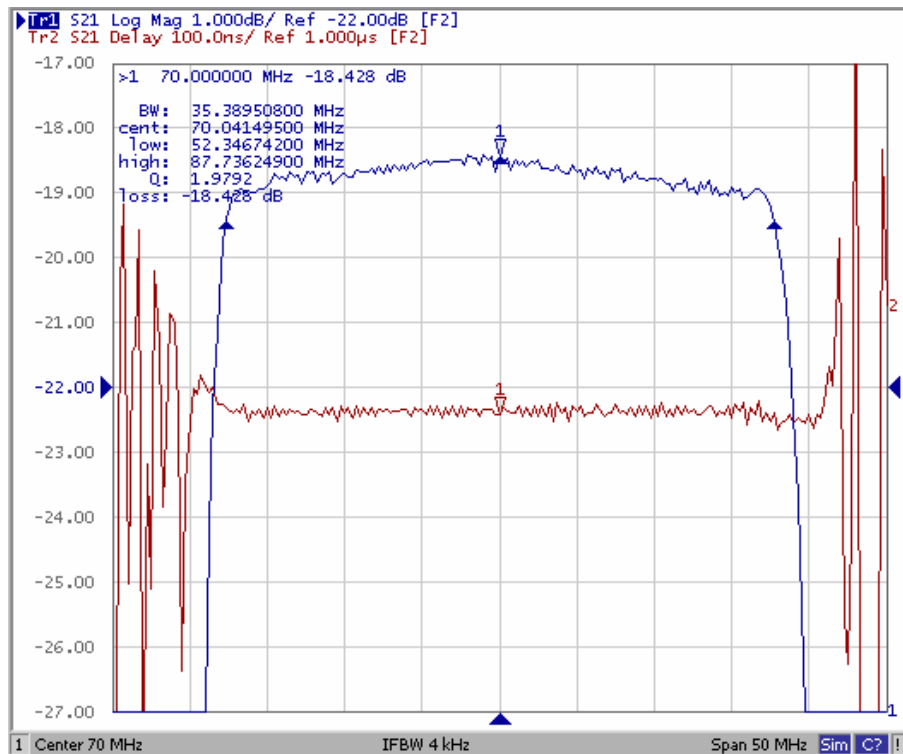

SAW Filter 70.0MHz
Part No: MP01881

Model: TB0474A
REV. NO.:1

(3) S11 Smith-Chart: (span 60MHz)

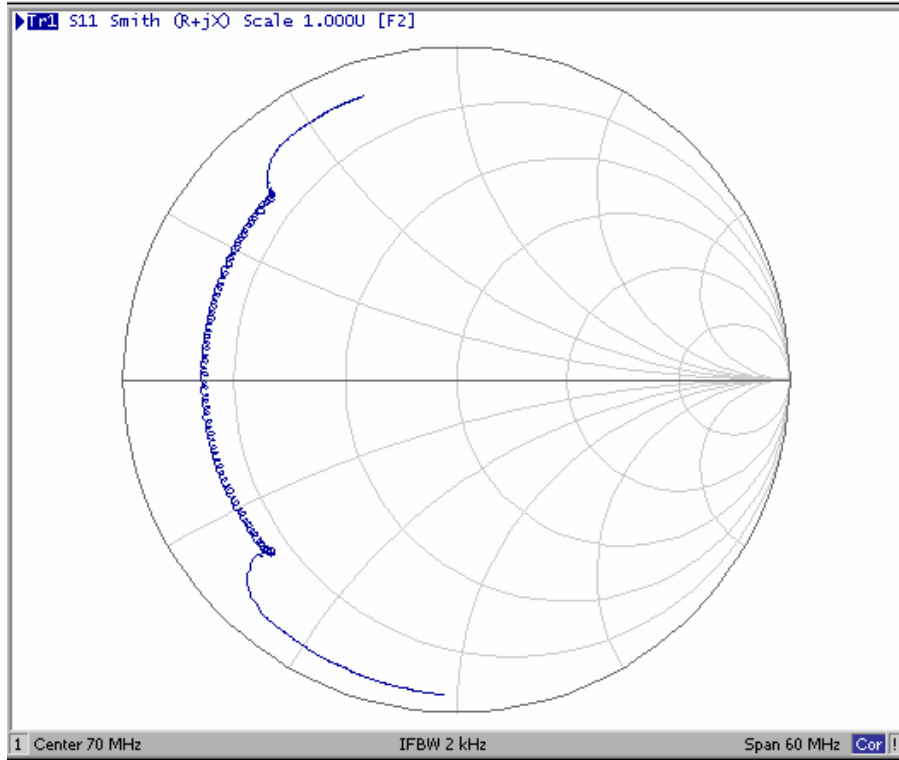

(4) S22 Smith-Chart: (span 60MHz)

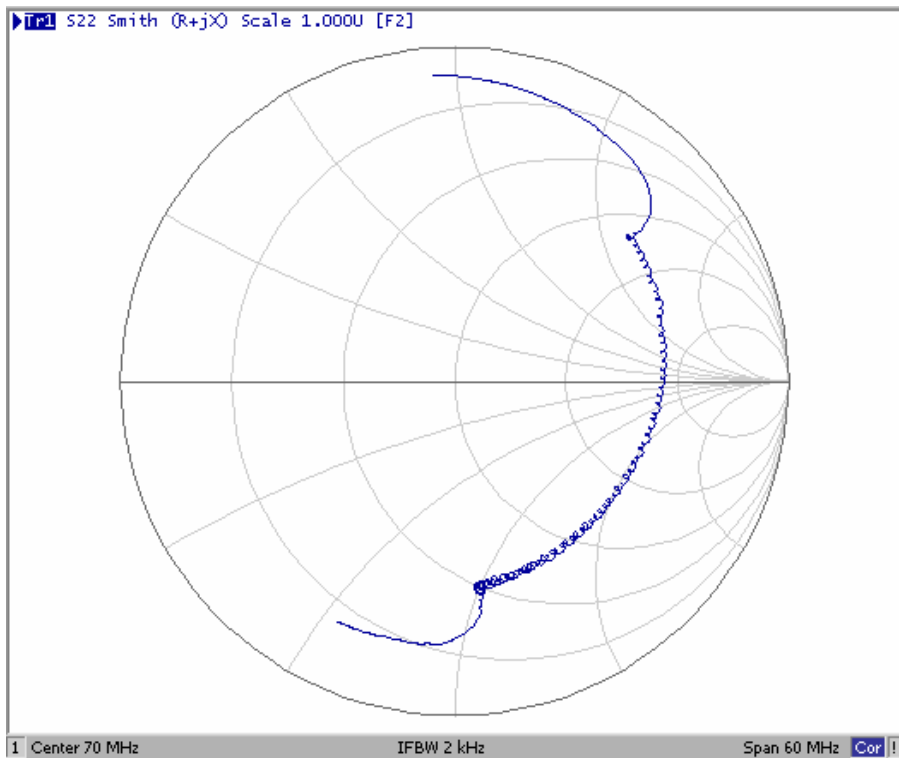

SAW Filter 70.0MHz

Model: TB0474A

Part No: MP01881

REV. NO.:1

D. OUTLINE DRAWING:

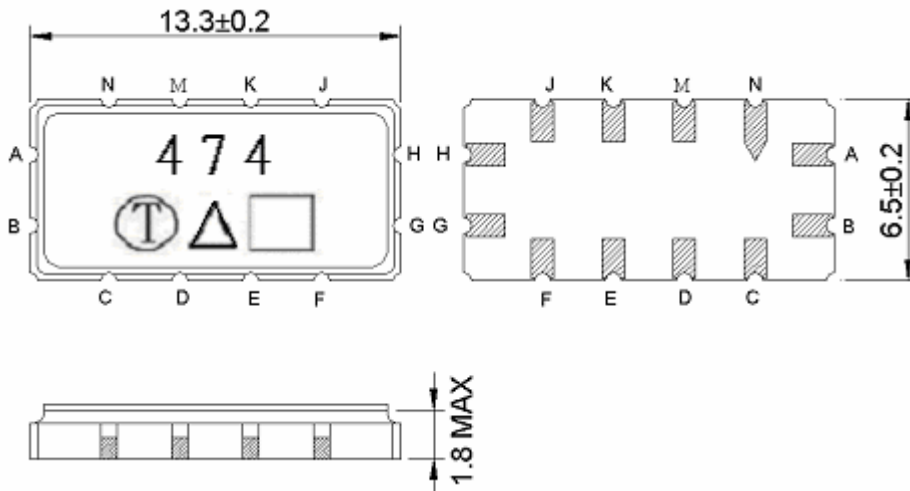

Pin A=B: RF input
 Pin H=G: RF output
 Pin C, D, E, F, J, K, N, M: To be Ground
 Unit : mm

E. MATCHING CIRCUIT:

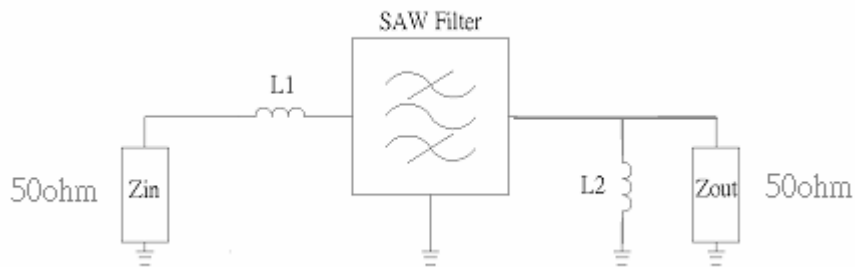

L1=90nH; L2=110nH.

SAW Filter 70.0MHz
Part No: **MP01881**

Model: TB0474A
REV. NO.:1

F. PACKING:

1. REEL DIMENSION

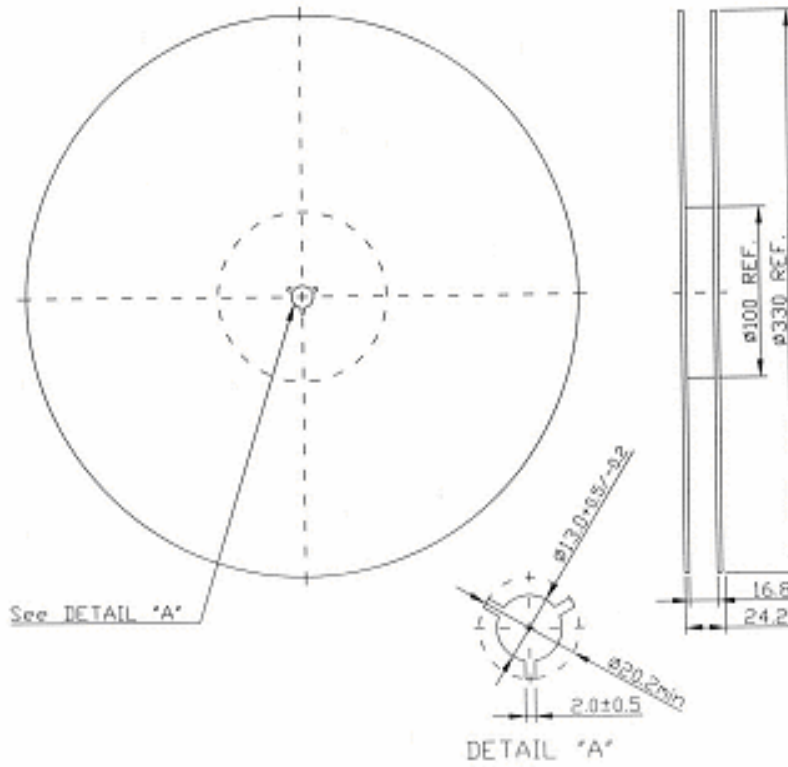

2. TAPE DIMENSION

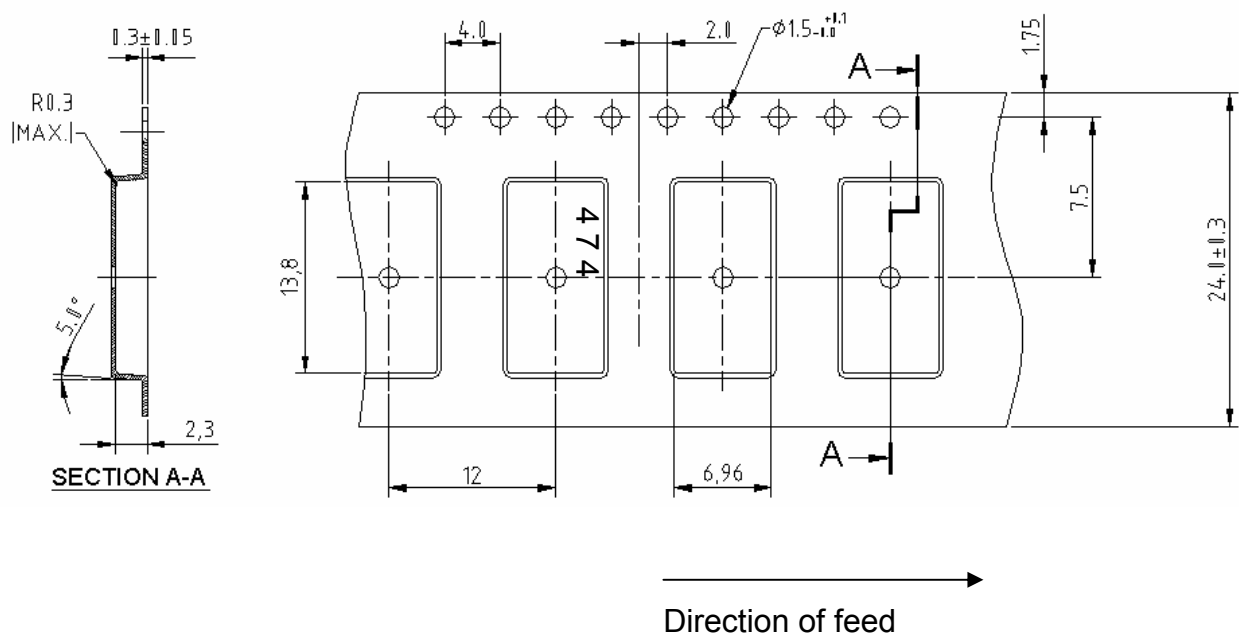

SAW Filter 70.0MHz

Model: TB0474A

Part No: MP01881

REV. NO.:1

G. RECOMMENDED REFLOW PROFILE:

