

SAW Filter 285MHz
Part No: MP01536

Model: TA0486A
REV. NO: 1

A. MAXIMUM RATING:

1. Input Power Level: 0dBm
2. DC voltage: 5 V
3. Operating Temperature: -10°C to +50°C
4. Storage Temperature: -40°C to +85°C

B. ELECTRICAL CHARACTERISTICS:

Characteristics	Specification			Note	
	Unit	Min.	Typ.		Max.
Center frequency Fc (MHz)		-	285	-	1
I.L. (Within Fc ± 4 MHz) (dB)		-	2.5	4.5	
Pass band BW _{3dB} (MHz)		8.0	12	-	1
Ripple (Within Fc ± 4MHz) (dB)		-	1.2	2.0	1
Attenuation (Reference level from 0dB)					
Fc - 100MHz to -37.5MHz (dB)		48	52	-	1
Fc + 37.5MHz to + 100MHz (dB)		48	52	-	
Impedance at Fc					
Input Z _{IN} = R _{IN} //C _{IN}			150 Ω // 0pF		2
Output Z _{OUT} = R _{OUT} //C _{OUT}			150 Ω // 0pF		2

Note1. The standard definitions is in JIS C 6703

Note2.

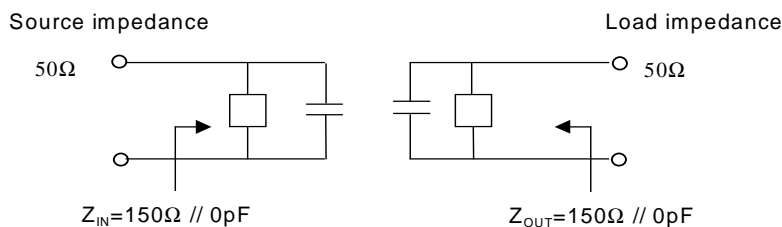

SAW Filter 285MHz
Part No: **MP01536**

Model: TA0486A
REV. NO: 1

C. FREQUENCY CHARACTERISTICS:

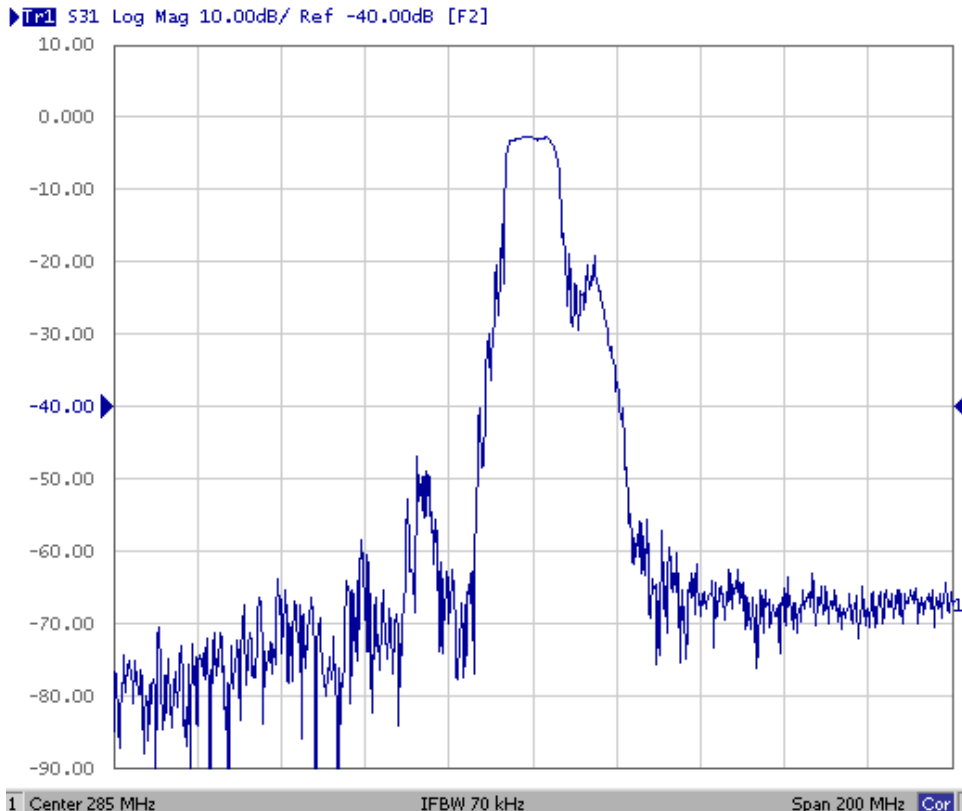
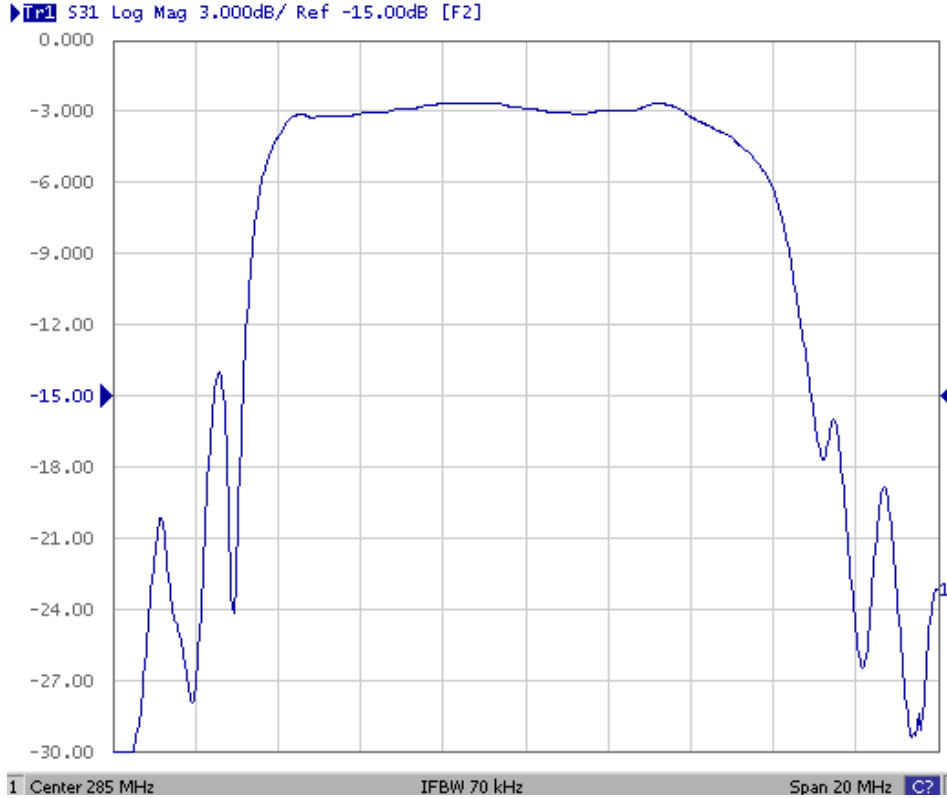

SAW Filter 285MHz

Model: TA0486A

Part No: MP01536

REV. NO: 1

D. MEASUREMENT CIRCUIT:

Network analyzer

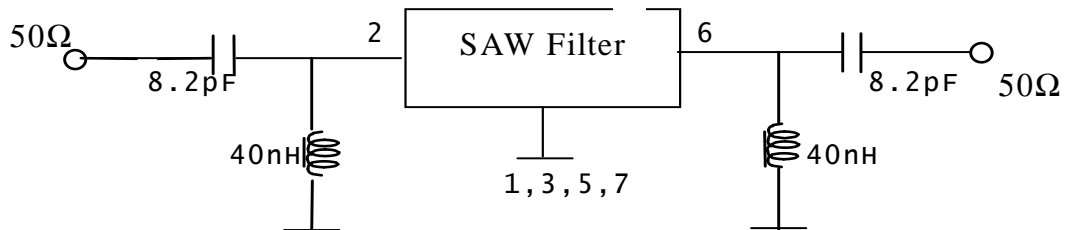

E. OUTLINE DRAWING:

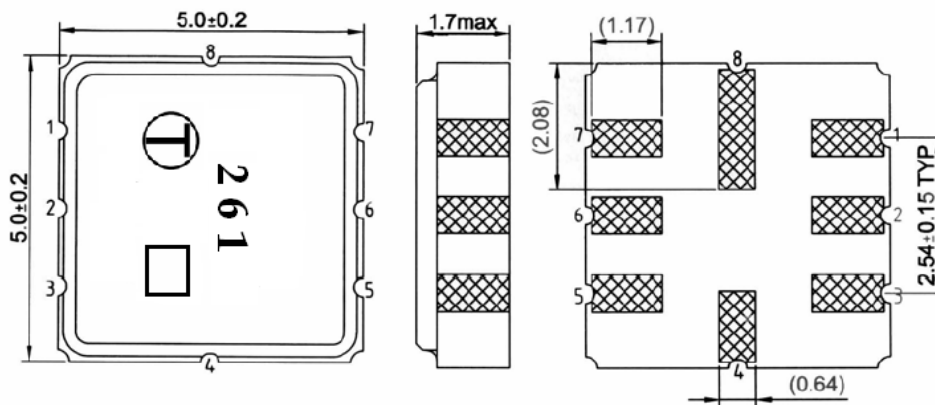

#2 : Input c
 #6 : Output o
 #4、8 : Case Ground
 #1、3、5、7 : Ground
 □ : Date code
 Unit : mm

SAW Filter 285MHz

Model: TA0486A

Part No: MP01536

REV. NO: 1

F. PCB FOOTPRINT:

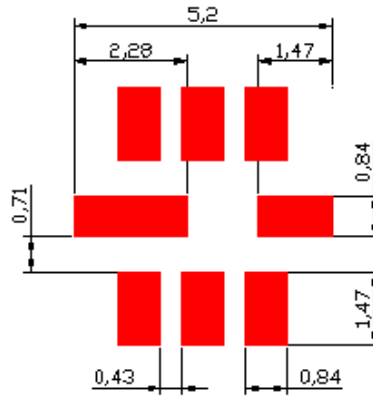

SAW Filter 285MHz
Part No: MP01536

Model: TA0486A
REV. NO: 1

G. PACKING:

1. REEL DIMENSION

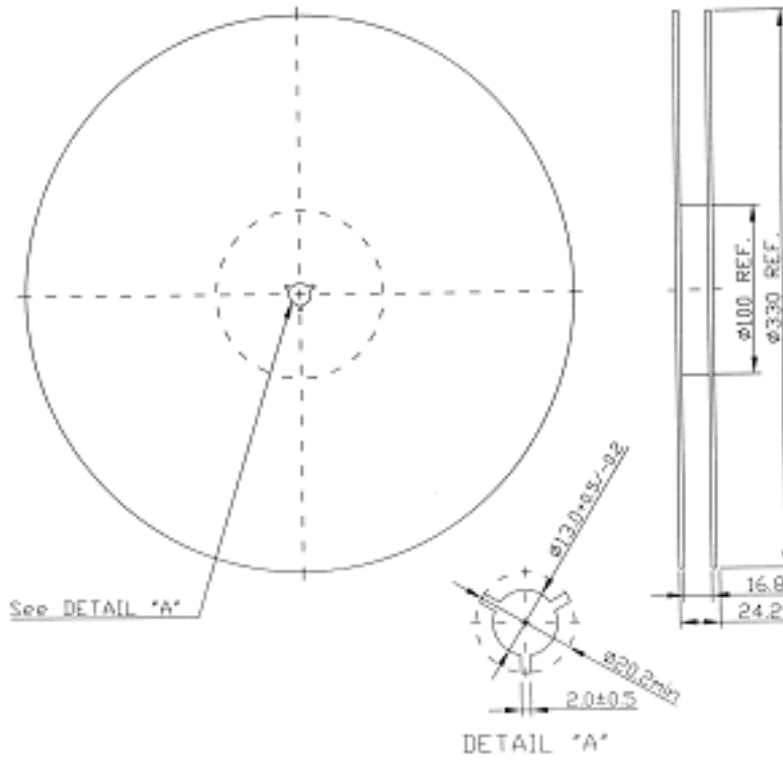

2. TAPE DIMENSION

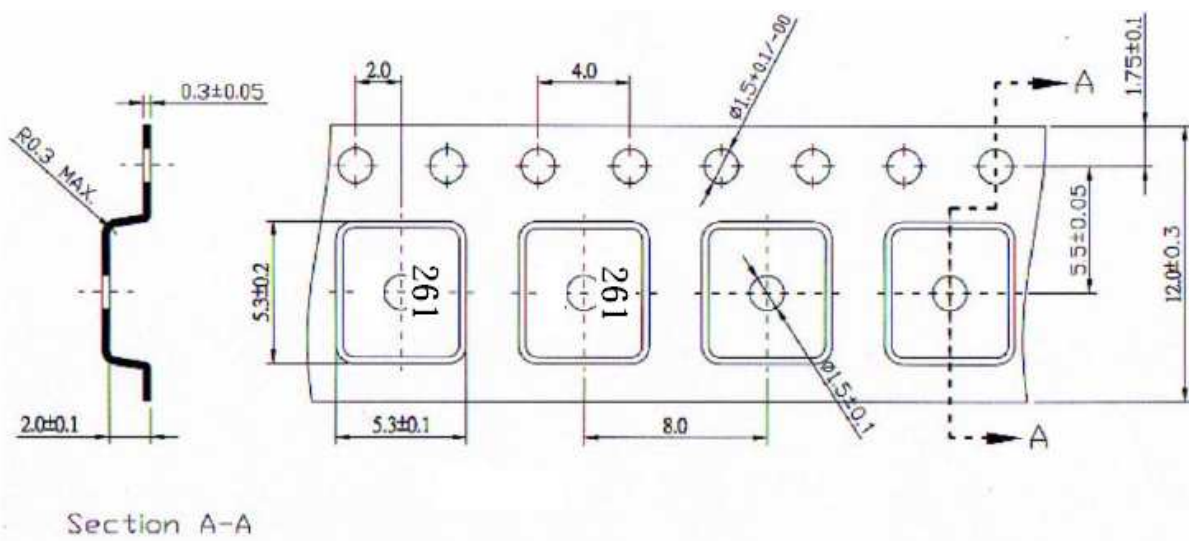

Direction of Feed
 →