

SAW Filter 435.0MHz

Model: TA0693A

Part No: MA09629

REV NO.:1

A. MAXIMUM RATING:

1. Input Power Level: 10 dBm
2. DC voltage: 3 V
3. Operating Temperature: -40°C to +85°C
4. Storage Temperature: -40°C to +85°C

B. ELECTRICAL CHARACTERISTICS:

Item		Min.	Typ.	Max.
Center frequency	Fc MHz	-	435	-
Insertion loss	430 ~ 440 MHz IL (dB)	-	2.3	3.3
Amplitude ripple	430 ~ 440 MHz (dB)	-	0.8	1.7
Attenuation (Reference level from 0 dB)				
Fc-100 to Fc-45	MHz (dB)	40	45	-
Fc+20	MHz (dB)	30	37	-
Fc+45 to Fc+55	MHz (dB)	30	40	-
Fc+55 to Fc+100	MHz (dB)	40	50	-
Source impedance	Zs (Ω)	-	50	-
Load impedance	ZL (Ω)	-	50	-

Note1. No matching network required for operation at 50 Ω

C. MEASUREMENT CIRCUIT:

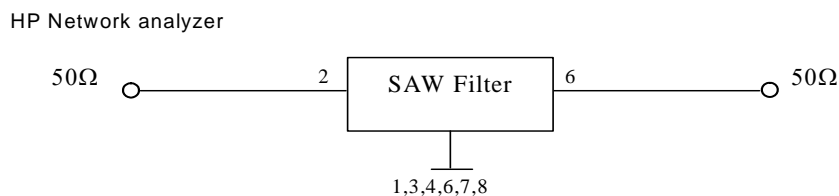

SAW Filter 435.0MHz
Part No: MA09629

Model: TA0693A
REV NO.:1

D. FREQUENCY CHARACTERISTICS:

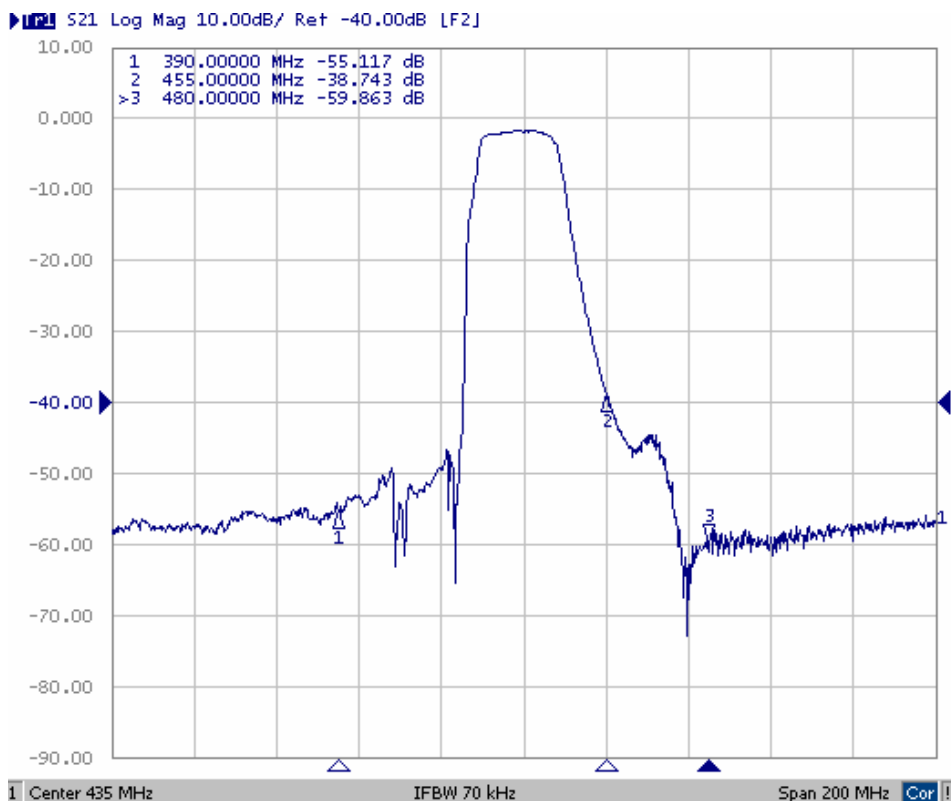
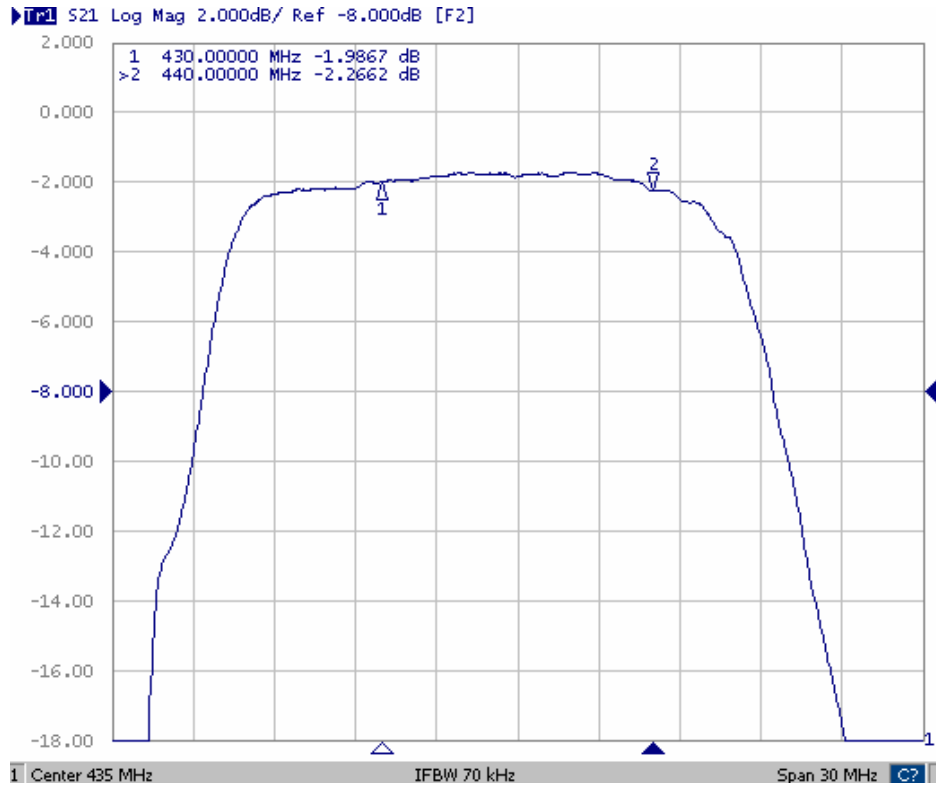

SAW Filter 435.0MHz
Part No: MA09629

Model: TA0693A
REV NO.:1

E. OUTLINE DRAWING:

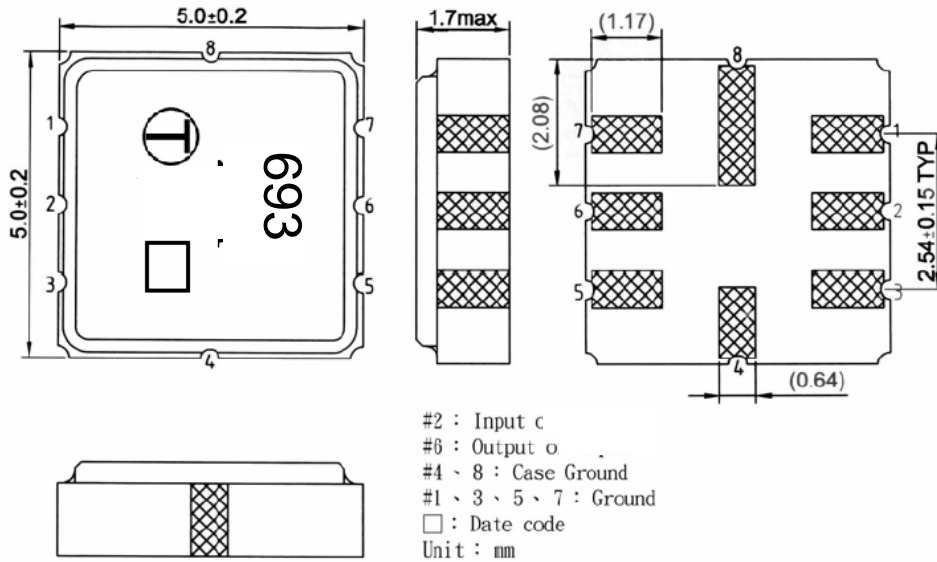

F. PCB FOOTPRINT:

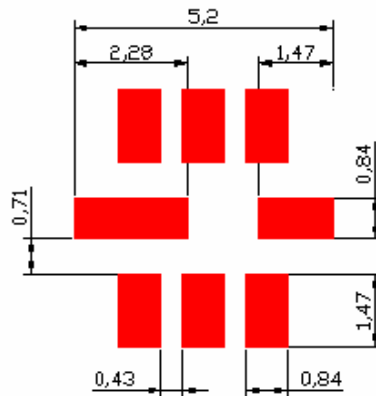

SAW Filter 435.0MHz
Part No: MA09629

Model: TA0693A
REV NO.:1

G. PACKING:

1. REEL DIMENSION

7"=1000
 13"=3000

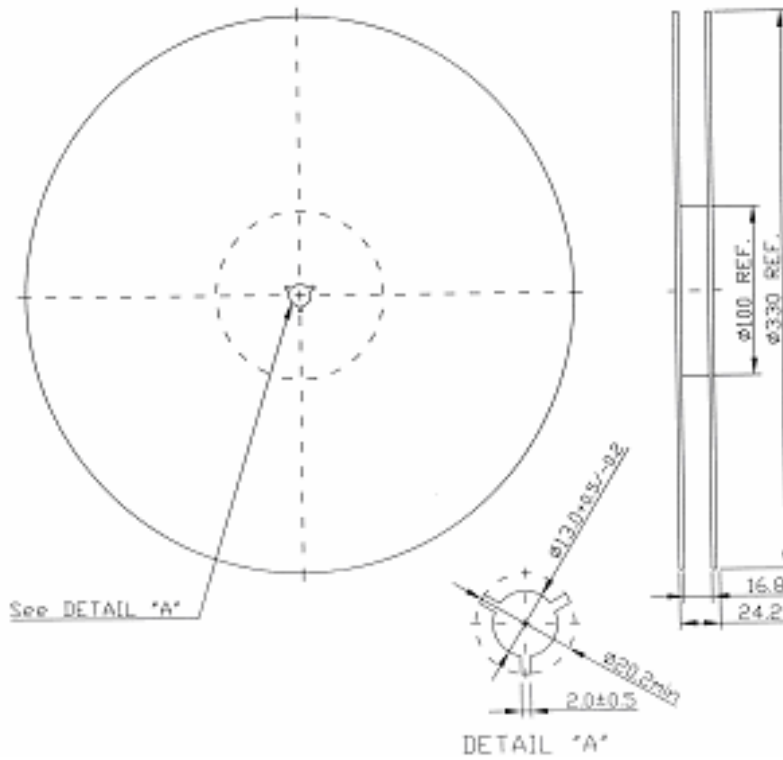

2. TAPE DIMENSION

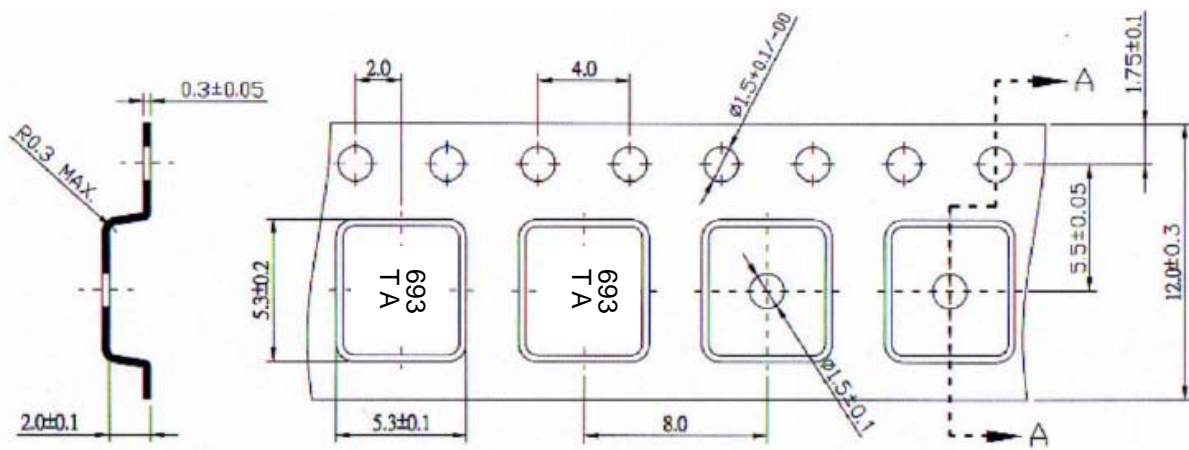

Section A-A

Direction of Feed

SAW Filter 435.0MHz
Part No: MA09629

Model: TA0693A
REV NO.:1

H. RECOMMENDED REFLOW PROFILE:

