

280.0MHz SAW Filter

Model: **TA0510A**

Part No: **MA09410**

REV NO.: 1

A. MAXIMUM RATING:

1. Input Power Level: 0 dBm
2. DC voltage: 5V
3. Operating Temperature: -10°C to +50°C
4. Storage Temperature: -40°C to +85°C

B. ELECTRICAL CHARACTERISTICS:

Item	Unit	Min.	Type.	Max.
Center frequency F_c	MHz	-	280	-
Insertion Loss $F_c \pm 4\text{MHz}$ IL_{max}	dB	-	3.0	4.5
3dB Bandwidth BW_{-3dB}	MHz	8	12.5	-
Ripple $F_c \pm 4\text{MHz}$	dB	-	0.8	2
Absolute Attenuation:(Reference level 0dB)				
$F_c -100$ to $F_c -37.5$ MHz	dB	42	53	-
$F_c +37.5$ to $F_c +100$ MHz	dB	48	60	-

Note: IL_{min} is the minimum of the pass band attenuation. The bandwidth BW_{-3dB} is the difference value of the upper and lower frequencies at the 3dB filter attenuation level relative to the IL_{min} .

C. MEASUREMENT CIRCUIT:

HP Network analyzer

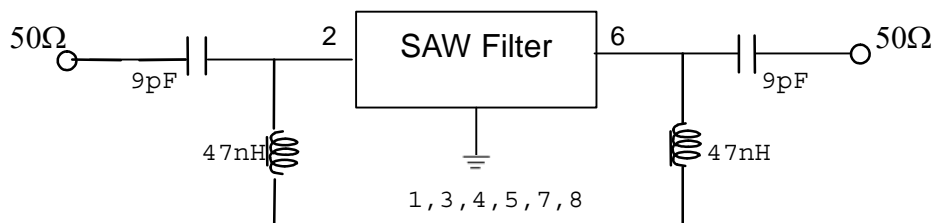

280.0MHz SAW Filter
Part No: **MA09410**

Model: **TA0510A**
REV NO.: 1

C. FREQUENCY CHARACTERISTICS:

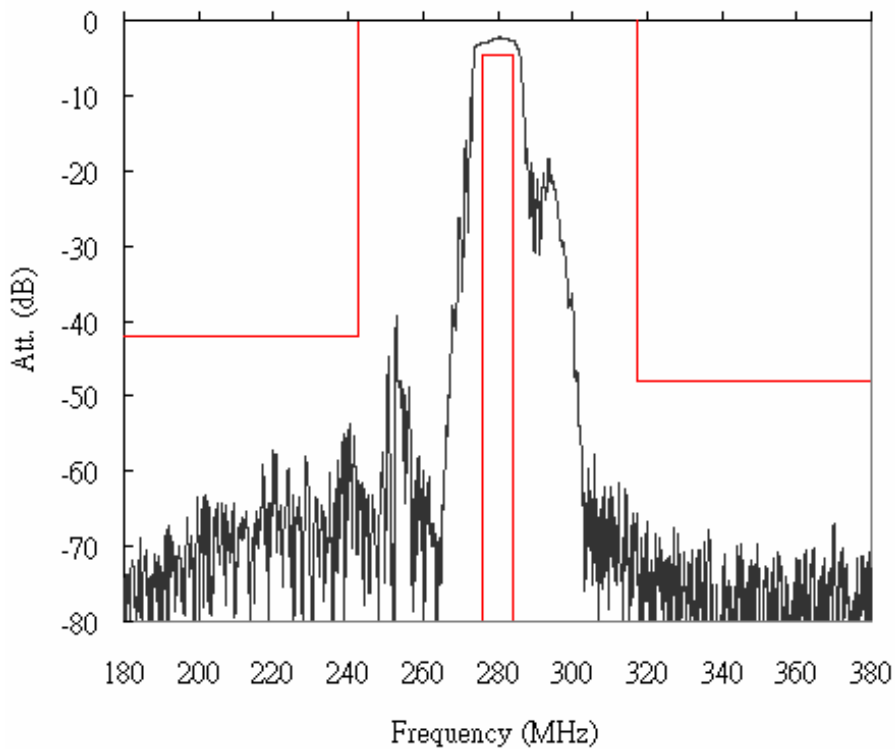
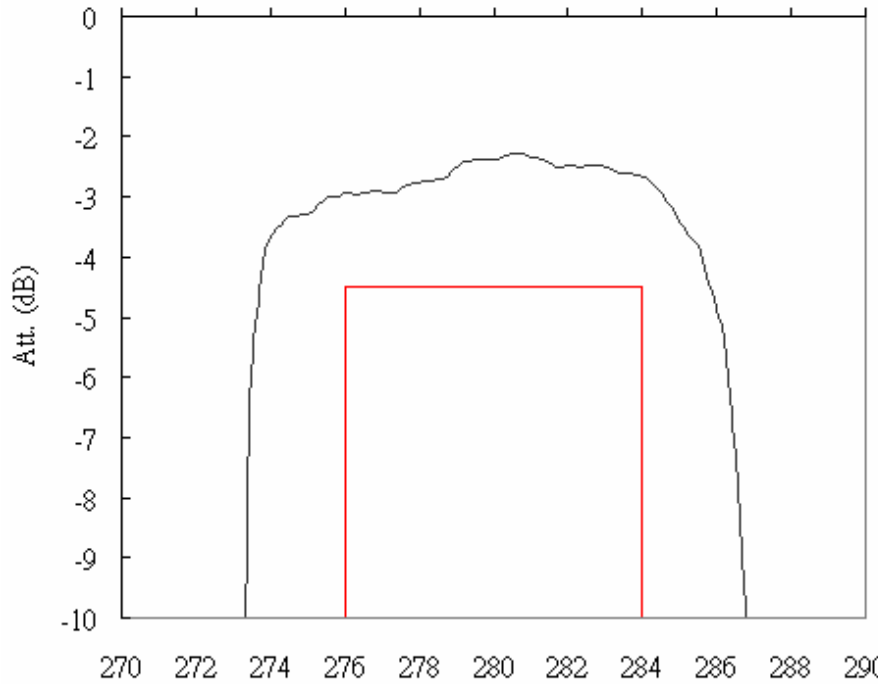

280.0MHz SAW Filter
Part No: MA09410

Model: TA0510A
REV NO.: 1

D. OUTLINE DRAWING:

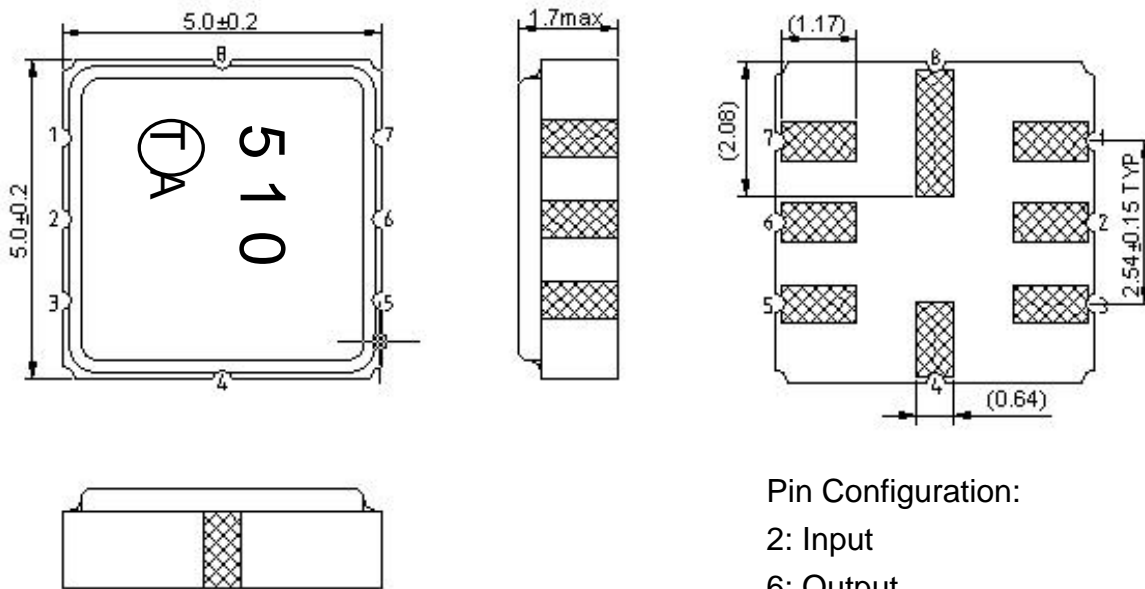

Pin Configuration:

2: Input

6: Output

1,3,4,5,7,8: Ground

Unit: mm

E. PCB FOOTPRINT:

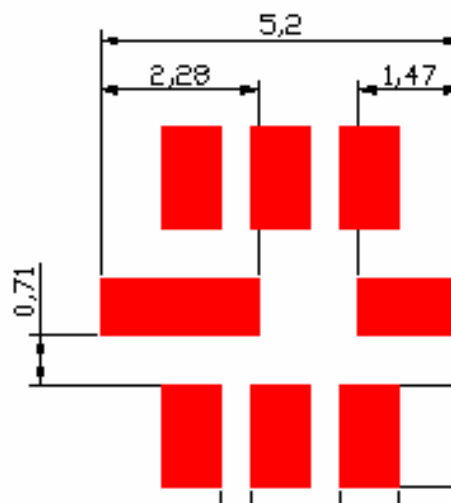

280.0MHz SAW Filter
Part No: MA09410

Model: TA0510A
REV NO.: 1

F. PACKING:

1. REEL DIMENSION

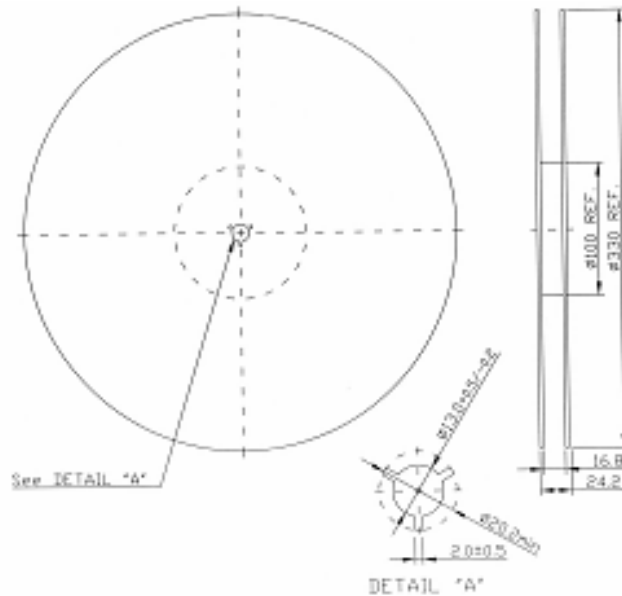

2. TAPE DIMENSION

