

**315.0MHz SAW Filter**

Model: **TA0672A**

Part No: **MA09065**

REV NO.: 1

**A. MAXIMUM RATING:**

1. Input Power Level: 10 dBm
2. DC voltage: 5 V
3. Operating Temperature: -30°C to 85°C
4. Storage Temperature: -30°C to +85°C

**B. CHARACTERISTICS:**

Item		Specification			
		Unit	Min.	Typ.	Max.
Center Frequency	Fc	MHz	-	315	-
Insertion Loss	Fc±5MHz	dB	-	2.5	4.0
Bandwidth	BW	MHz	10	15	-
Ripple	Fc±5MHz		-	1	2.0
Absolute Attenuation(reference to 0 dB)					
	10 ~ 295 MHz	dB	36	50	-
	345 ~ 680 MHz	dB	36	47	-
Source impedance	Zs	Ω	-	50	-
Load impedance	ZL	Ω	-	50	-
Temperature coefficient		ppm/k		-37	

Note1. No matching network required for operation at 50Ω

**C. MEASUREMENT CIRCUIT:**

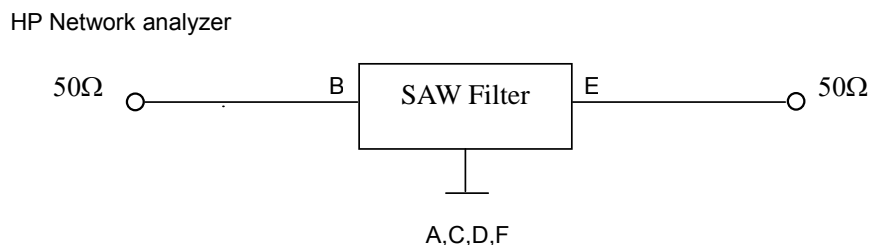

**315.0MHz SAW Filter**  
**Part No: MA09065**

**Model: TA0672A**  
**REV NO.: 1**

**D. TRANSFER FUNCTION:**

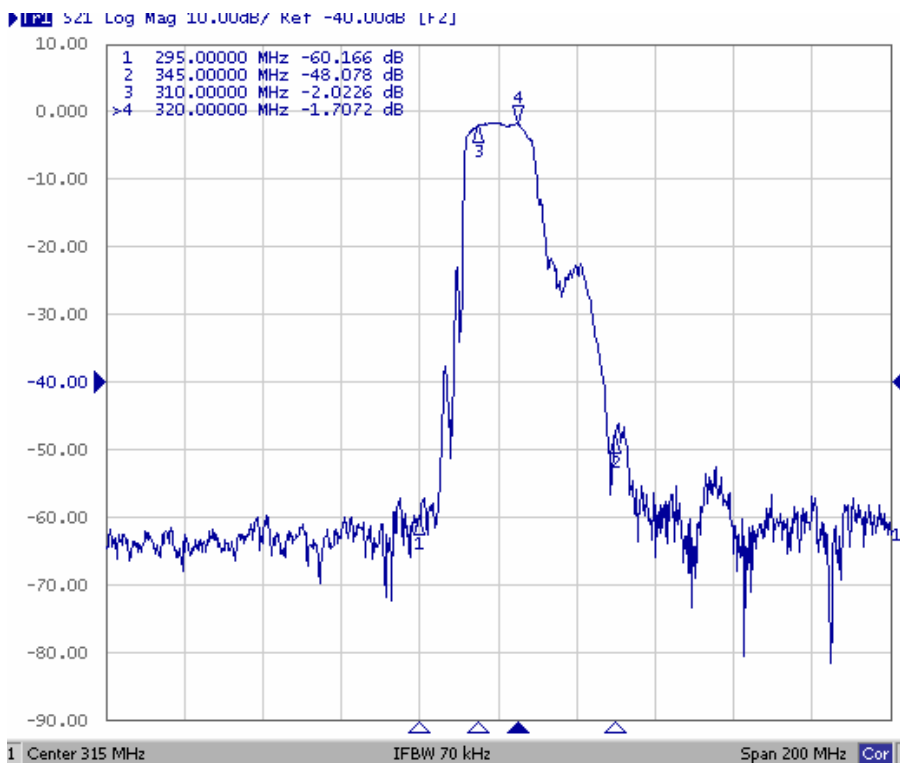
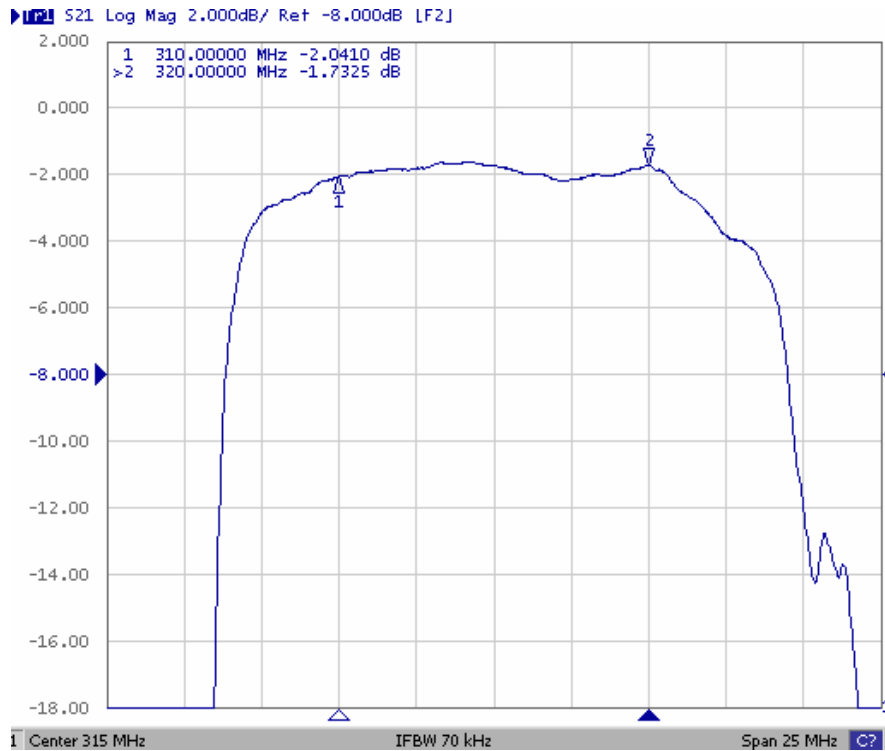

**315.0MHz SAW Filter**  
**Part No: MA09065**

**Model: TA0672A**  
**REV NO.: 1**

**E. OUTLINE DRAWING:**

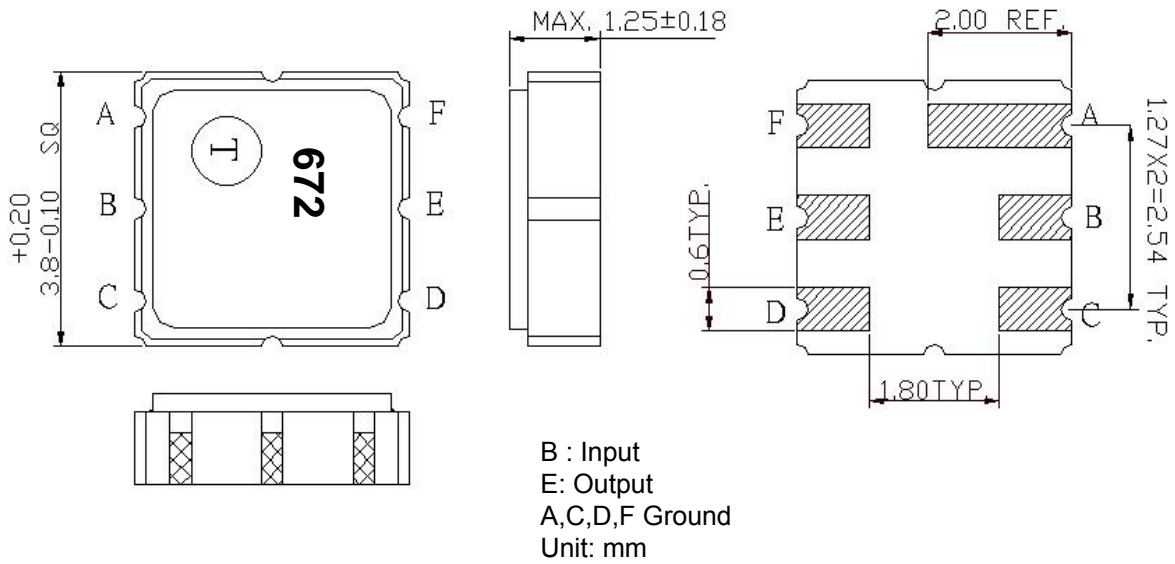

**F. PCB FOOTPRINT:**

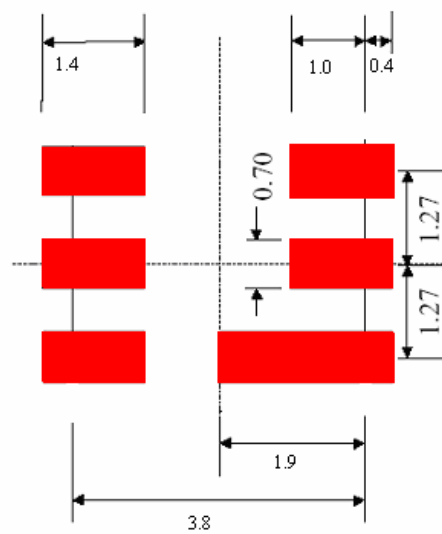

**315.0MHz SAW Filter**  
Part No: **MA09065**

Model: **TA0672A**  
REV NO.: 1

**G. PACKING:**

1. REEL DIMENSION

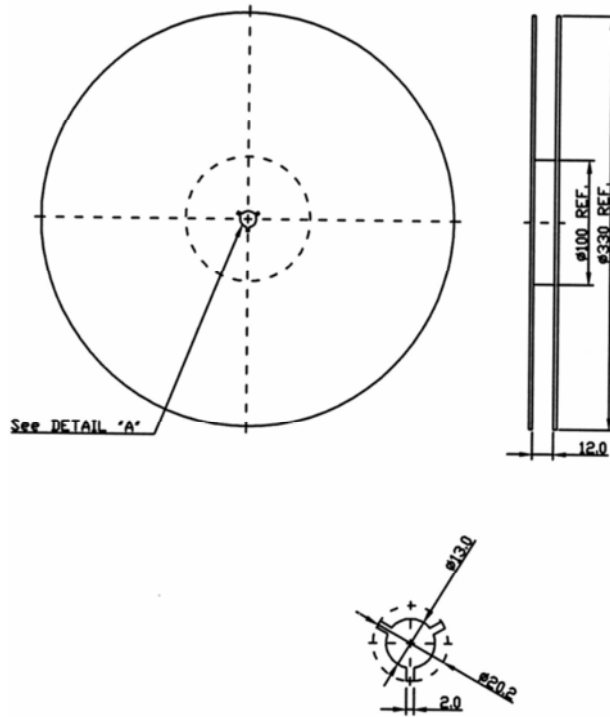

2. TAPE DIMENSION

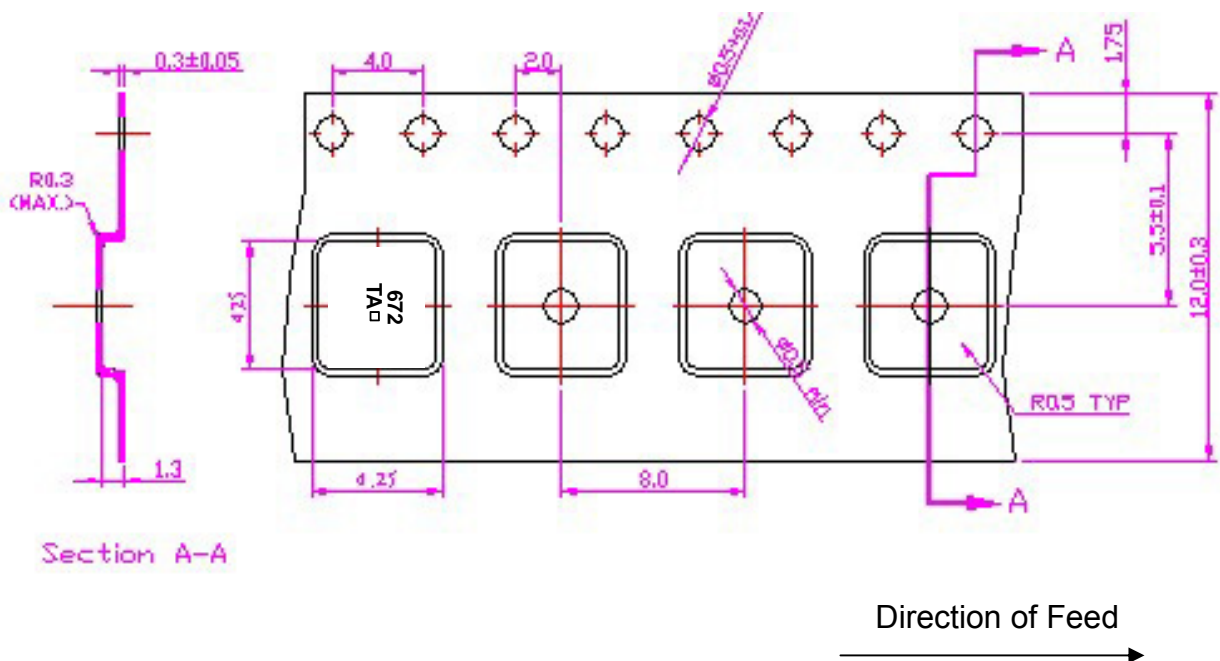

**315.0MHz SAW Filter**

**Model: TA0672A**

**Part No: MA09065**

**REV NO.: 1**

**H. REFLOW PROFILE:**

