

169MHz SAW Filter

Model: **TA0437A**

Part No: **MA07107**

REV NO: 1

A. MAXIMUM RATING:

1. Input Power Level: 10dBm
2. DC voltage: 3V
3. Operating Temperature: -10°C to +70°C
4. Storage Temperature: -40°C to +85°C

B. ELECTRICAL CHARACTERISTICS:

Item		Unit	Specification		
			Min.	Typ.	Max.
Center Frequency	F _c	MHz	-	169	-
Insertion Loss	IL _{min} (reference level)	dB	-	1.5	2.8
Bandwidth	BW	MHz	6	8.8	-
Absolute Attenuation(reference to IL _{min} dB)					
F _c -50 ~ F _c -30	MHz	dB	42	54	-
F _c -30 ~ F _c -15	MHz	dB	36	52	-
F _c +30 ~ F _c +50	MHz	dB	40	51	-
Source impedance	Z _s	Ω	-	50	-
Load impedance	Z _L	Ω	-	50	-

Note: IL_{min} is the minimum of the pass band attenuation. The center frequency F_c is the mean value of the upper and lower frequencies at the 3dB filter attenuation level relative to the IL_{min}.

169MHz SAW Filter

Model: **TA0437A**

Part No: **MA07107**

REV NO: 1

C. FREQUENCY CHARACTERISTICS:

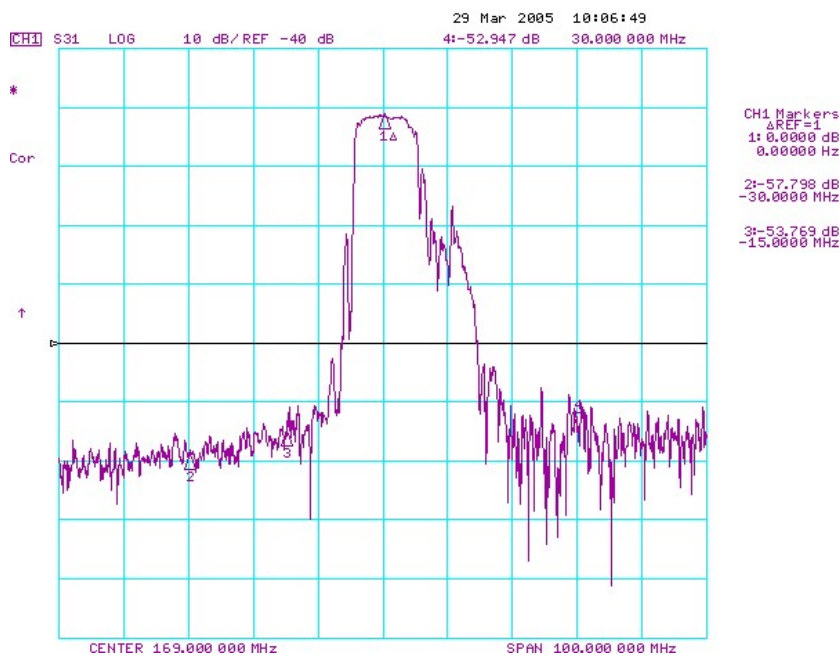
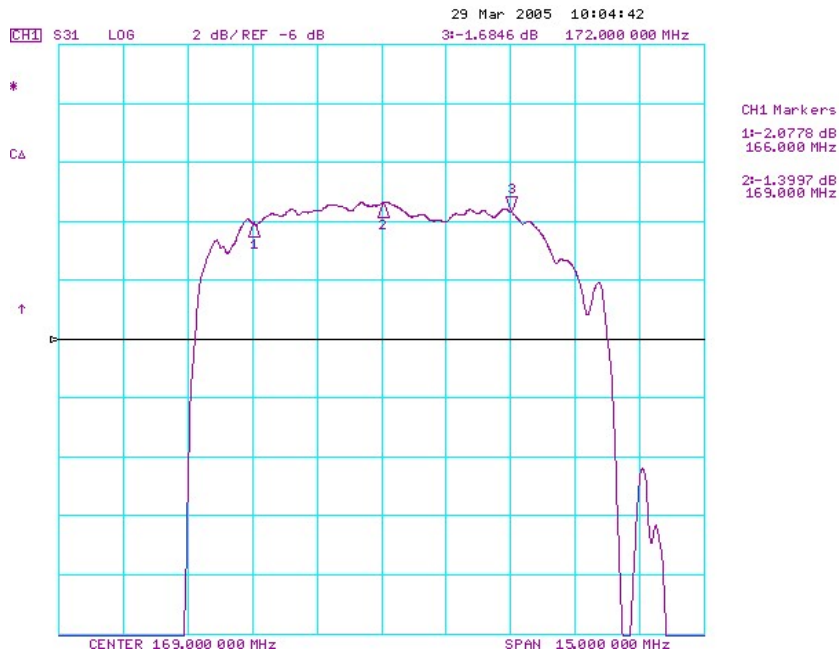

169MHz SAW Filter

Model: **TA0437A**

Part No: **MA07107**

REV NO: 1

D. MEASUREMENT CIRCUIT:

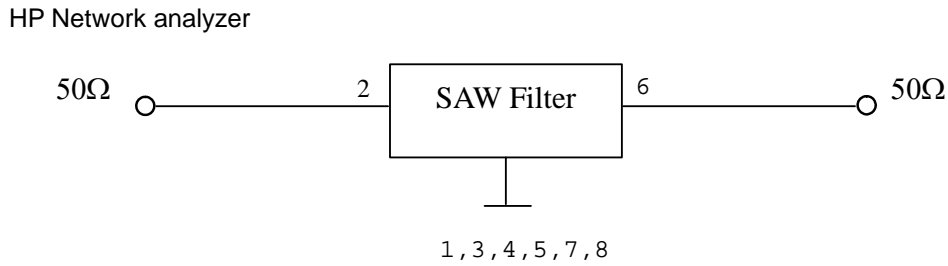

E. OUTLINE DRAWING:

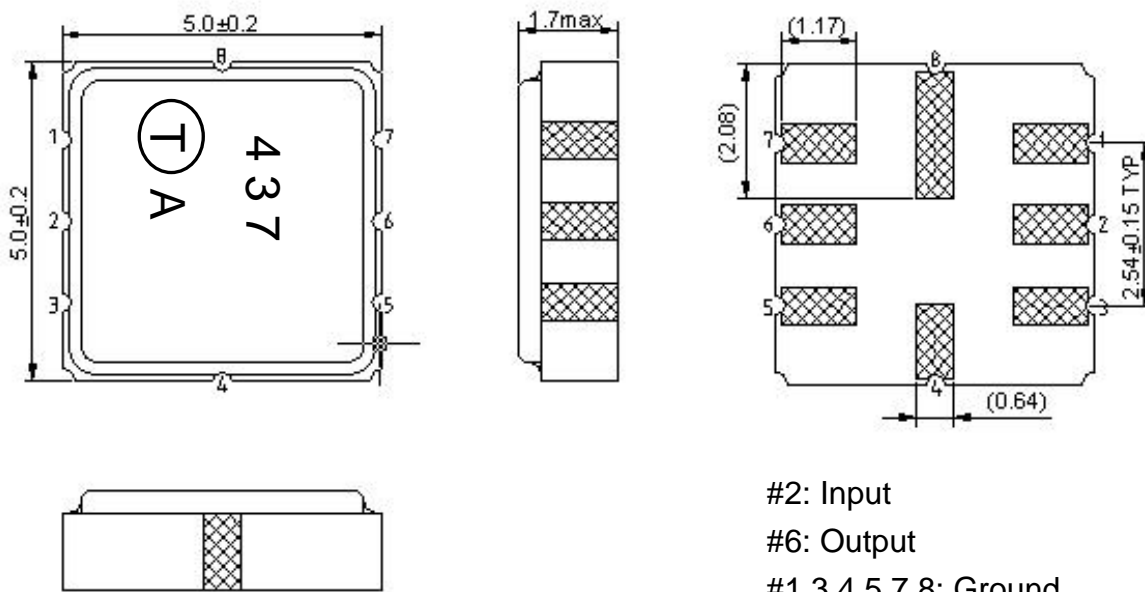

#2: Input
 #6: Output
 #1,3,4,5,7,8: Ground
 Unit: mm

F. PCB FOOTPRINT:

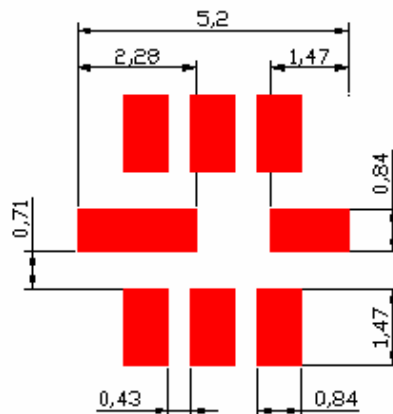

169MHz SAW Filter

Model: **TA0437A**

Part No: **MA07107**

REV NO: 1

G. PACKING:

1. REEL DIMENSION

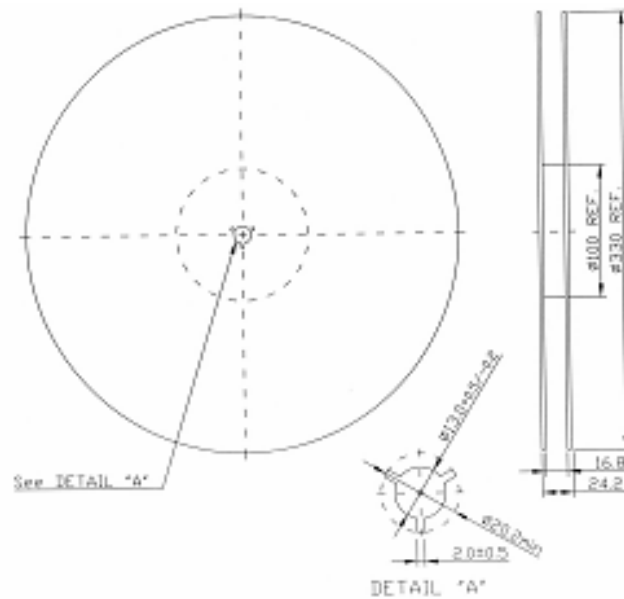

2. TAPE DIMENSION

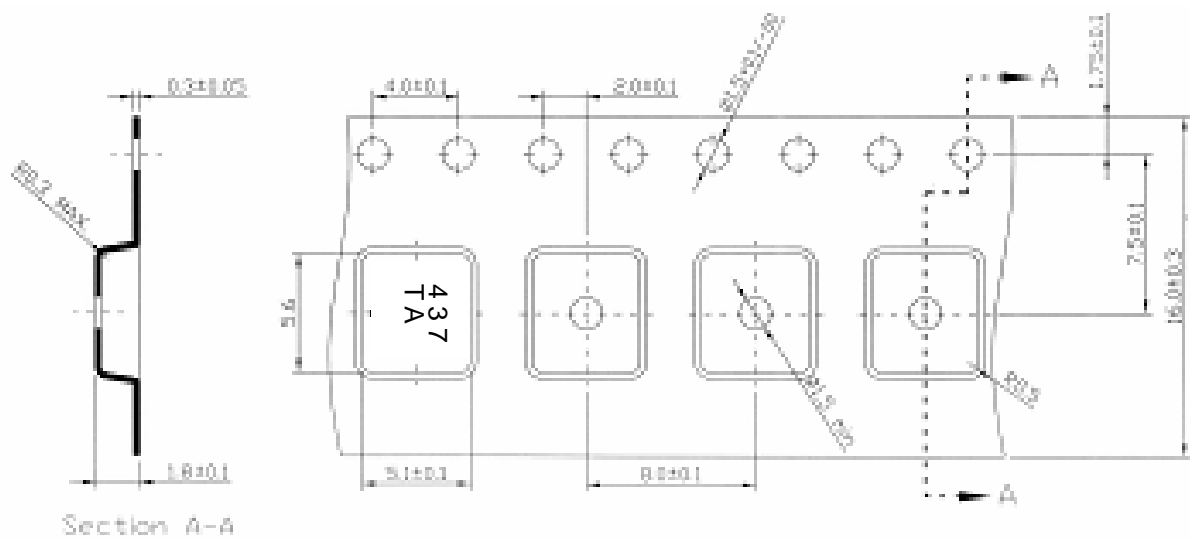

Direction of Feed