

SAW Filter 315.0MHz

Model: TA0209A

Part No: MA05553

REV. NO.: 3

A. MAXIMUM RATING:

1. Input Power Level: 10 dBm
2. DC voltage: 12 V
3. Operating Temperature: -40°C to +85°C
4. Storage Temperature: -40°C to +85°C

B. ELECTRICAL CHARACTERISTICS:

Item	Min.	Typ.	Max.	Note
Center frequency F_c (MHz)	-	315	-	1
Minimum I.L. (314.82~315.22 MHz) (dB) IL_{min}	-	2.0	4.0	
Pass band (relative to IL_{min})				
314.77~315.2 MHz (dB)	-	1.5	3.0	1
314.71~315.26 MHz (dB)	-	2.0	6.0	
Pass bandwidth (relative to IL_{min}) BW_3 (KHz)	800	920	-	
Attenuation:(relative to IL_{min}) (dB)				
10~270 MHz (dB)	45	55	-	1
270~309 MHz (dB)	30	35	-	
309~313.94 MHz (dB)	15	20	-	
316~335 MHz (dB)	10	15	-	
335~400 MHz (dB)	35	45	-	
400~1000 MHz (dB)	45	55	-	
Impedance at F_c ; Input $Z_{IN}=R_{IN}/C_{IN}$ Output $Z_{OUT}=R_{OUT}/C_{OUT}$	344Ω // 4.9 pF 344Ω // 4.9 pF			
Turnover To (deg.C)	25 typ.			

Note1. The standard definitions is in JIS C 6703

SAW Filter 315.0MHz
Part No: MA05553

Model: TA0209A
REV. NO.: 3

C. FREQUENCY CHARACTERISTICS:

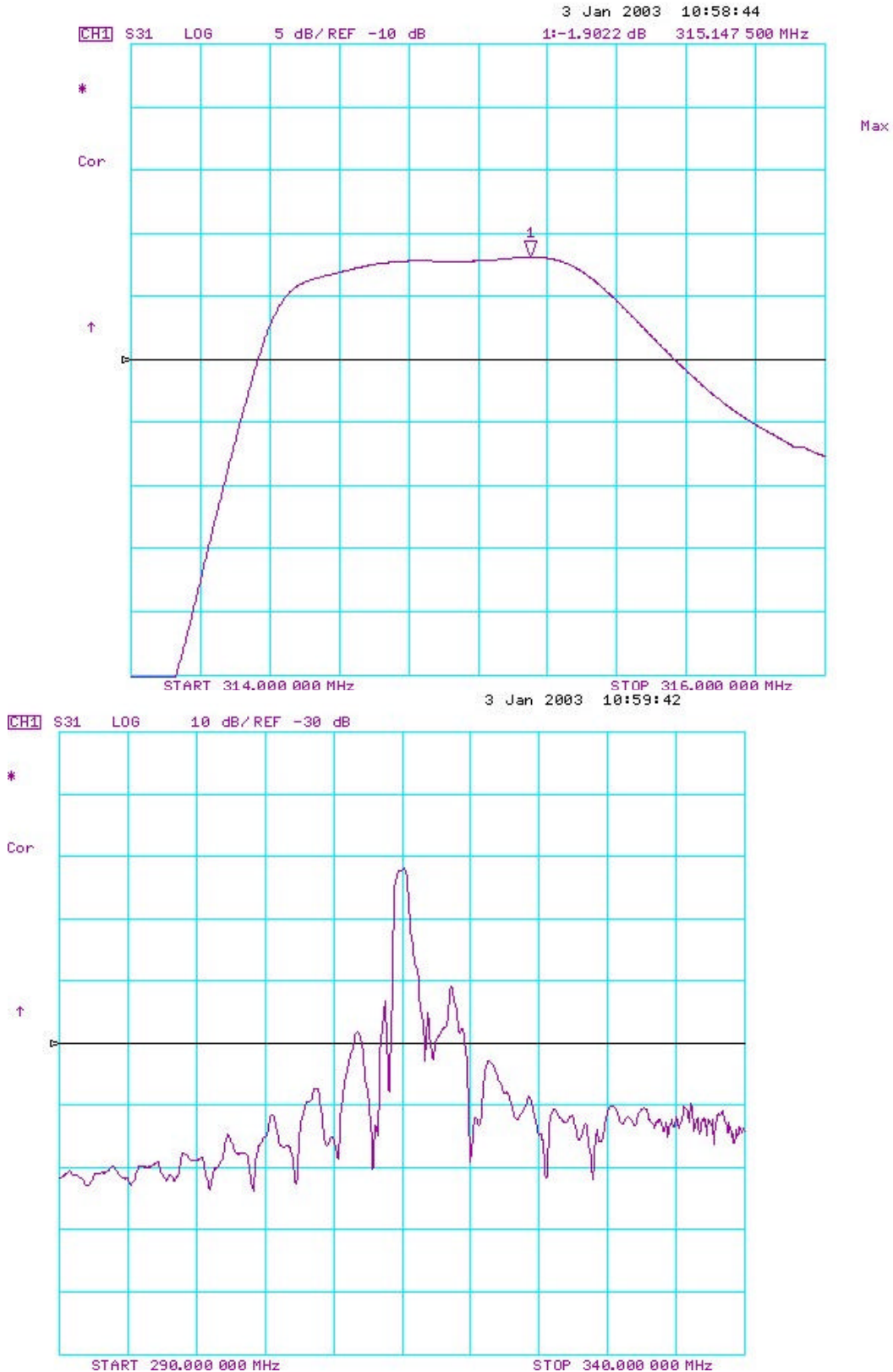

SAW Filter 315.0MHz

Model: TA0209A

Part No: MA05553

REV. NO.: 3

D. MEASUREMENT CIRCUIT:

HP Network analyzer

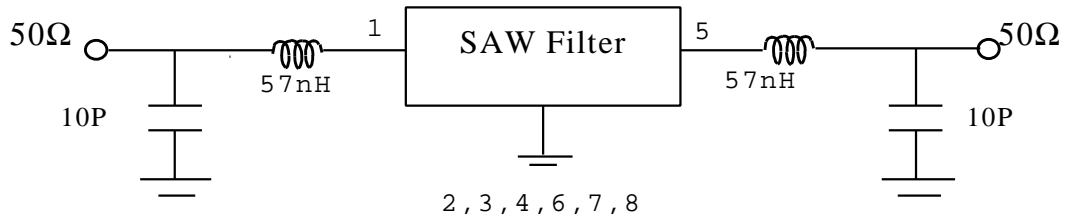

E. OUTLINE DRAWING:

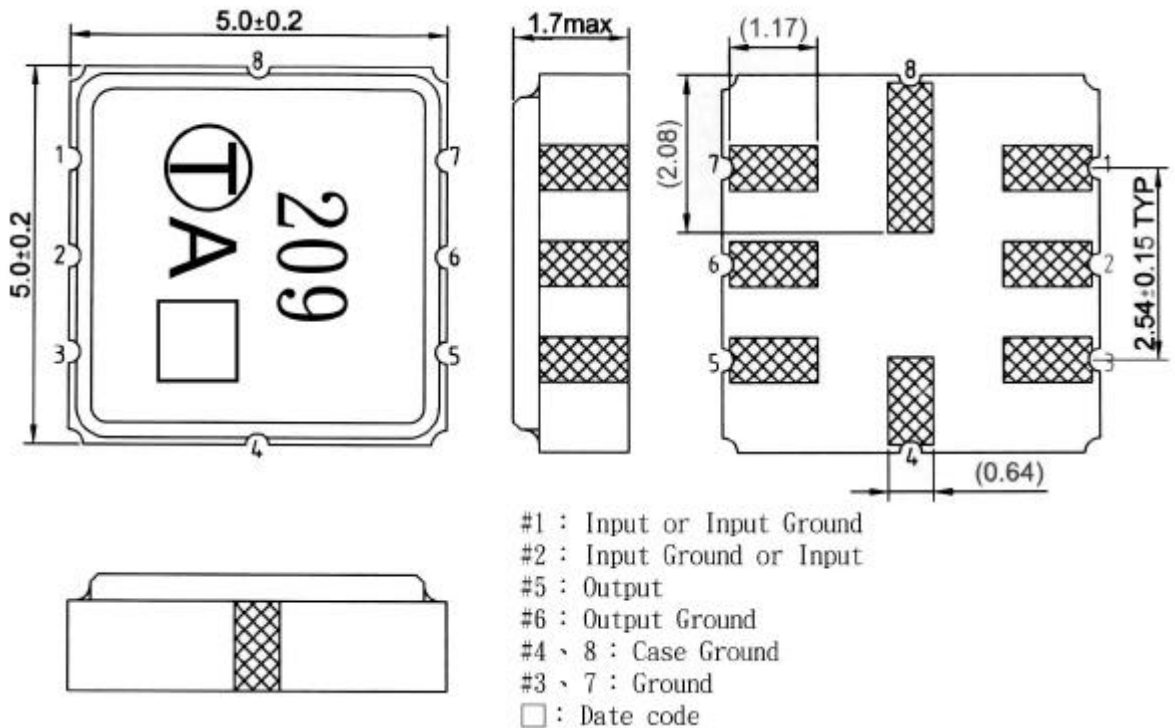

SAW Filter 315.0MHz
Part No: MA05553

Model: TA0209A
REV. NO.: 3

F. PACKING:

1. REEL DIMENSION

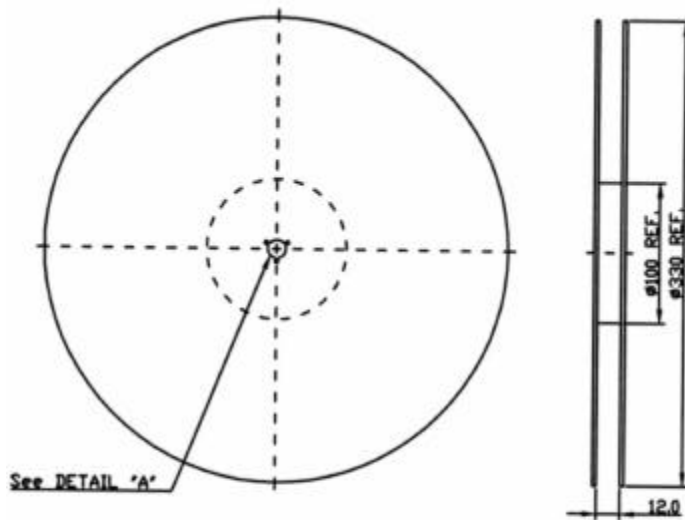

2. TAPE DIMENSION

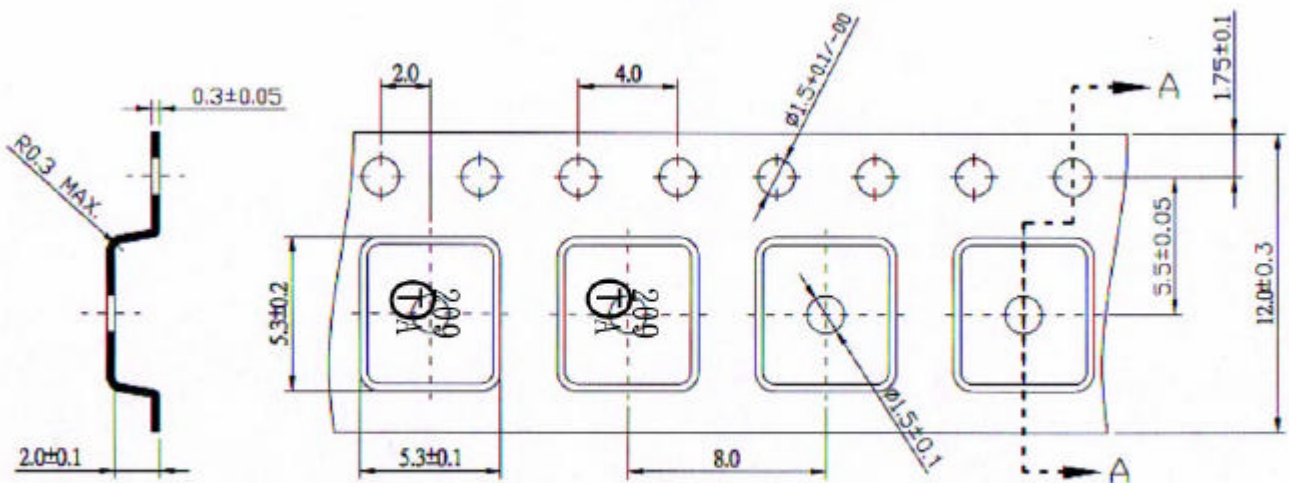

Section A-A