

SMD 5x7 mm SAW Filter 119.64 MHz
Part No: MA05334

Model: TB0196A
Rev: 1.0

A. MAXIMUM RATING:

1. Input Power Level: 10 dBm
2. DC voltage : 13V
3. Operating Temperature: -20°C to 75°C
4. Storage Temperature: -40°C to 85°C

B. ELECTRICAL CHARACTERISTICS:

Item	Unit	Min.	Type.	Max.	Note
Center frequency, Fc	MHz	-	119.64	-	1
Minimum Insertion Loss, IL	dB	-	4	5.5	1
3 dB bandwidth (from Fc)	KHz	15	-	-	1
Group delay ripple in Fc 15KHz, GD	µs	-	5	10	1
Attenuation:(Reference level from min IL)					
Fc - 15 to Fc + 15 KHz	dB	-	1.2	3.0	
Fc 60 to Fc 120 KHz	dB	13	23	-	
Fc 120 to Fc 240 KHz	dB	43	50	-	
Fc 240 to Fc 330 KHz	dB	45	55	-	
Fc 330 to Fc 480 KHz	dB	45	55	-	
Fc 480 to Fc 660 KHz	dB	45	55	-	

Note1. The standard definitions is in JIS C 6703

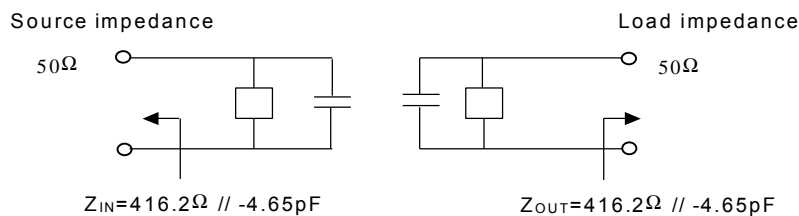

SMD 5x7 mm SAW Filter 119.64 MHz
Part No: MA05334

Model: TB0196A
Rev: 1.0

C. OUTLINE DRAWING:

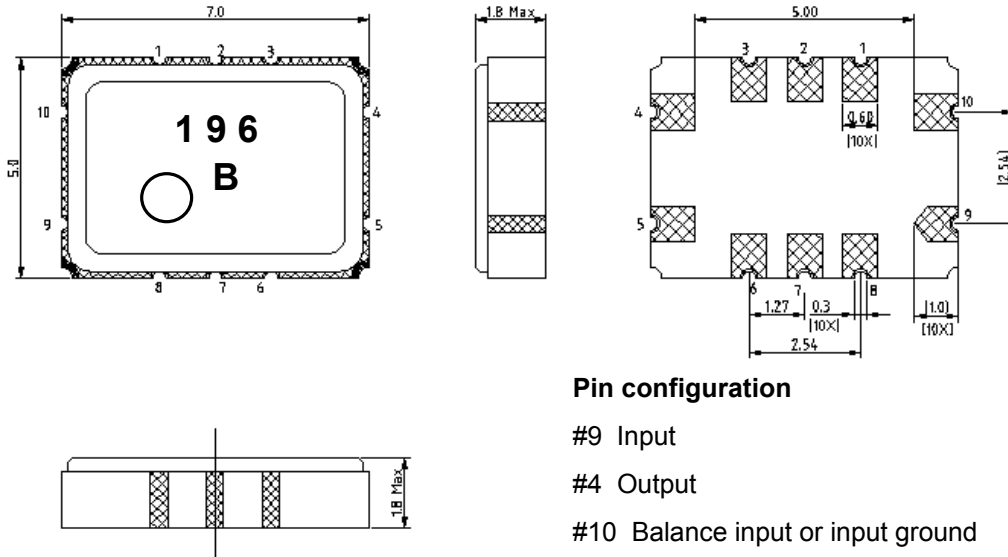

Pin configuration

- #9 Input
- #4 Output
- #10 Balance input or input ground
- #5 Balance output or output ground
- #1,2,3,6,7,8 To be grounded

D. MEASUREMENT CIRCUIT:

50 Ohm Test circuit 1 (single-ended / single-ended)

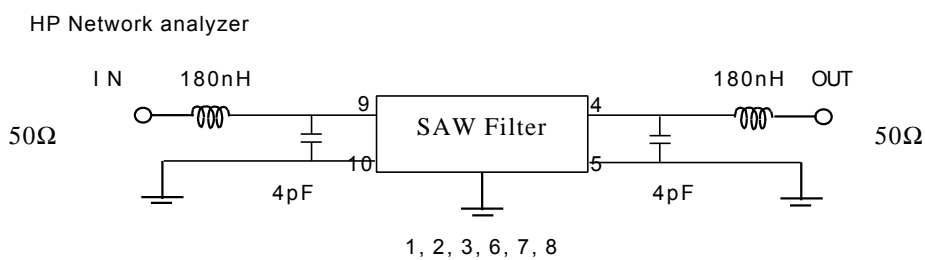

50 Ohm Test circuit 2 (balance / balance)

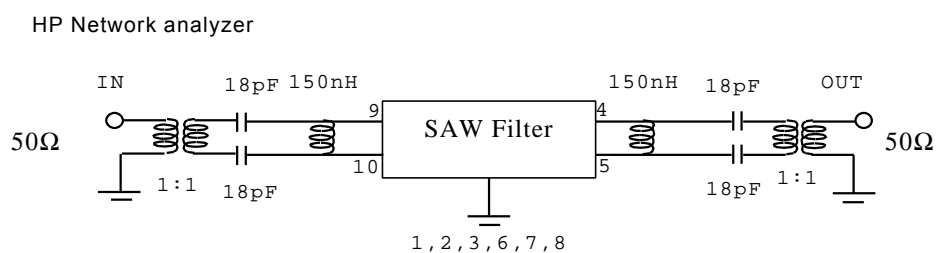

SMD 5x7 mm SAW Filter 119.64 MHz
Part No: MA05334

Model: TB0196A
Rev: 1.0

E. FREQUENCY CHARACTERISTICS:

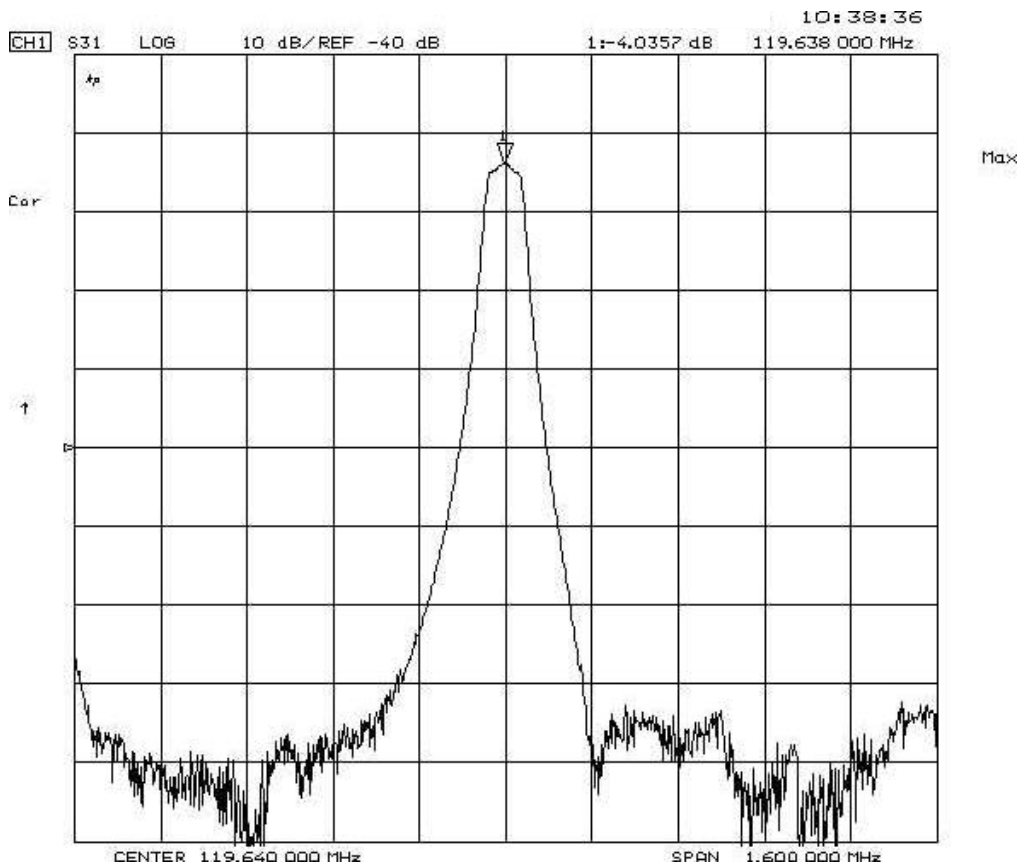
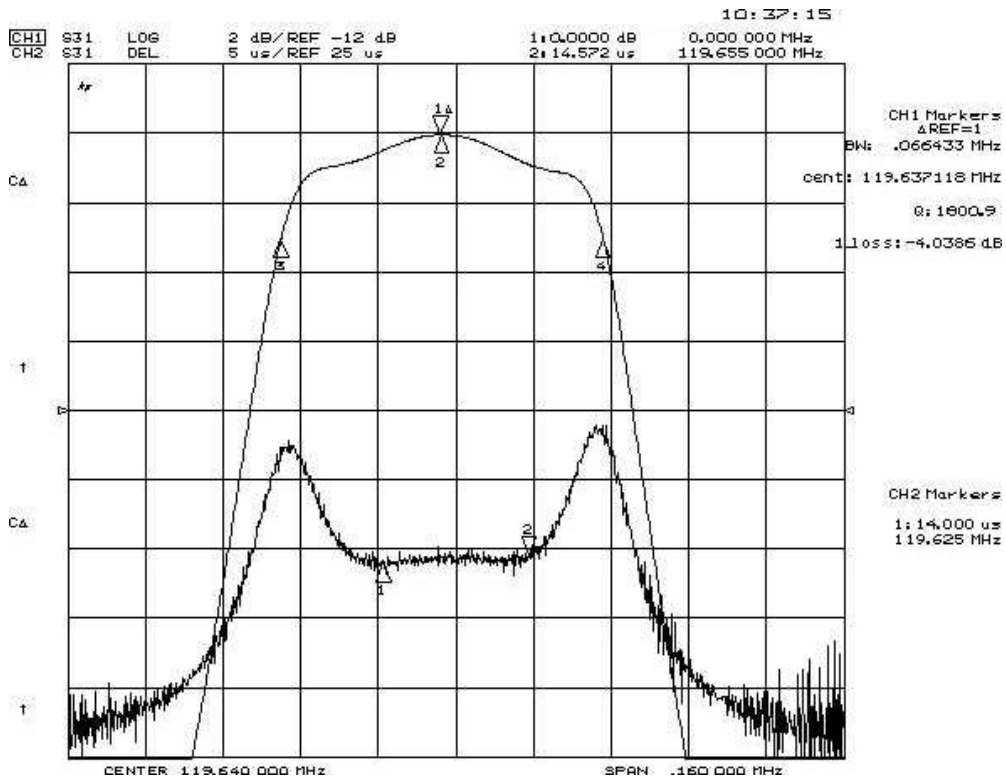

SMD 5x7 mm SAW Filter 119.64 MHz
Part No: **MA05334**

Model: TB0196A
Rev: 1.0

F. PACKING:

1. REEL DIMENSION

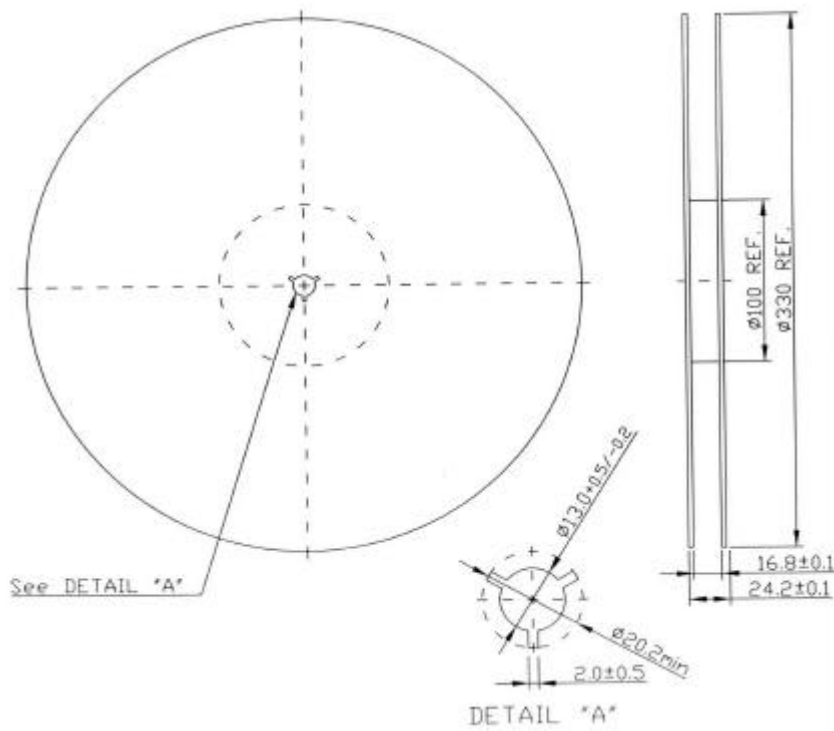

2. TAPE DIMENSION

