

**SAW Filter 433.920MHz**  
**Part No: MA04316**

**Model: TA0278A**  
**REV. NO.: 2**

**A. MAXIMUM RATING:**

1. Input Power Level: 0 dB<sub>m</sub>
2. DC voltage: 0V
3. Operating Temperature: -15°C to +60°C
4. Storage Temperature: -40°C to +85°C

**B. ELECTRICAL CHARACTERISTICS:**

Item	Unit	Min.	Typ.	Max.
Center frequency F <sub>c</sub>	MHz	-	433.92	-
Insertion Loss IL <sub>min</sub> (reference level)	dB	-	2.3	3.5
3dB Bandwidth BW <sub>3dB</sub>	MHz	4	7.8	-
Attenuation:(Reference level from IL <sub>min</sub> )				
F <sub>c</sub> -100 to F <sub>c</sub> -200	MHz dB	56	69	-
F <sub>c</sub> -25 to F <sub>c</sub> -100	MHz dB	40	61	-
F <sub>c</sub> -10.7	MHz dB	42	51	-
F <sub>c</sub> +25 to F <sub>c</sub> +100	MHz dB	40	61	-
F <sub>c</sub> +100 to F <sub>c</sub> +200	MHz dB	40	52	-
Source impedance Z <sub>s</sub>	Ω	-	50	-
Load impedance Z <sub>L</sub>	Ω	-	50	-

Note: IL<sub>min</sub> is the minimum of the pass band attenuation. The center frequency F<sub>c</sub> is the mean value of the upper and lower frequencies at the 3dB filter attenuation level relative to the IL<sub>min</sub>.

**SAW Filter 433.920MHz**  
Part No: **MA04316**

**Model: TA0278A**  
REV. NO.: 2

**C. FREQUENCY CHARACTERISTICS:**

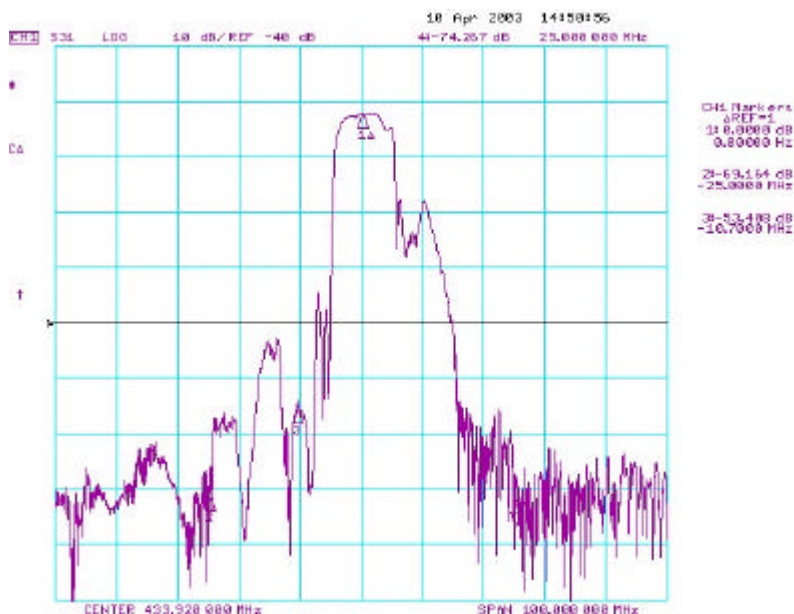
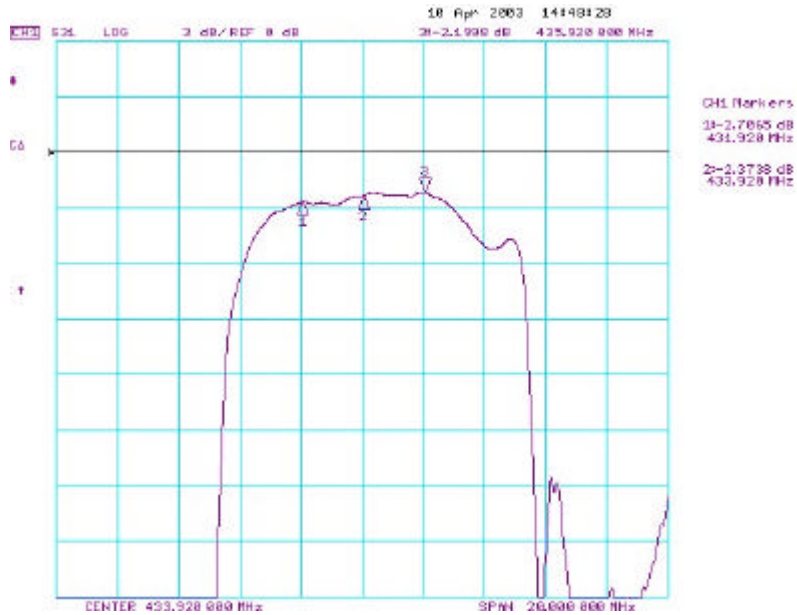

Tel: +44 1460 256 100  
Fax: +44 1460 256 101  
www.golledge.com



**Golledge Electronics Ltd**  
Ashwell Park, Ilminster  
Somerset, TA19 9DX, UK

---

---

**SAW Filter 433.920MHz**  
**Part No: MA04316**

---

---

**Model: TA0278A**  
**REV. NO.: 2**

**SAW Filter 433.920MHz**  
**Part No: MA04316**

**Model: TA0278A**  
**REV. NO.: 2**

**D. MEASUREMENT CIRCUIT:**

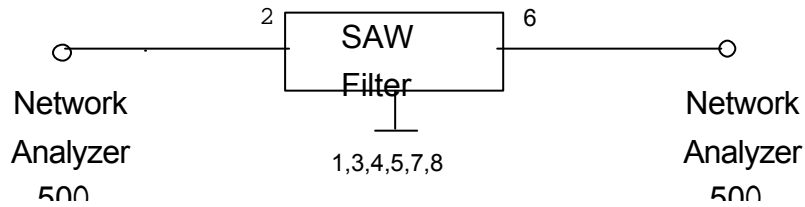

**E. OUTLINE DRAWING:**

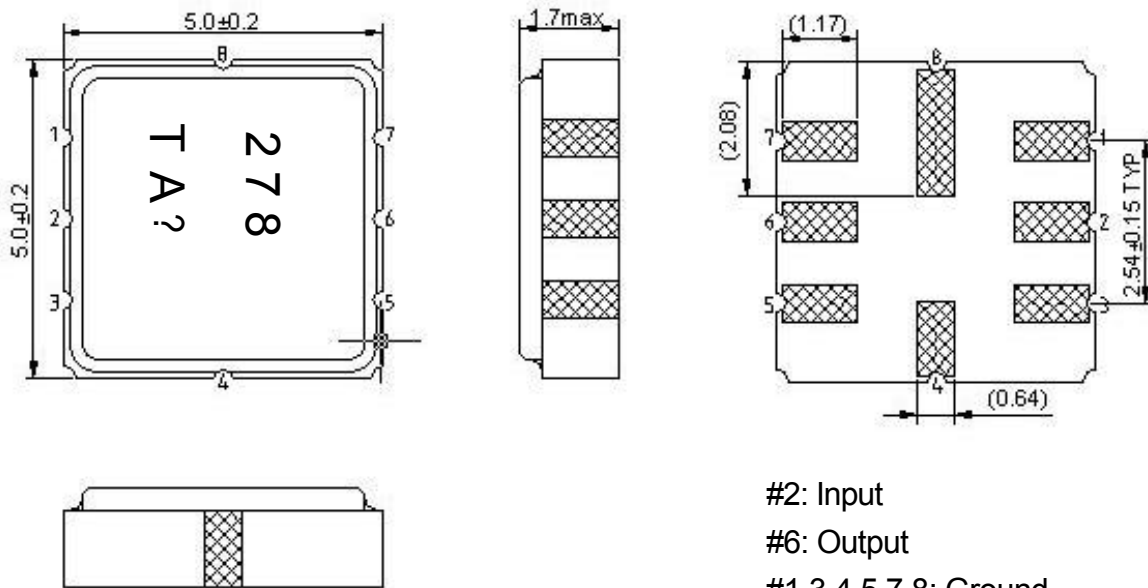

#2: Input  
 #6: Output  
 #1,3,4,5,7,8: Ground  
 ? : Date Code  
 Unit: mm

**SAW Filter 433.920MHz**  
**Part No: MA04316**

**Model: TA0278A**  
**REV. NO.: 2**

**F. PACKING:**

**1. REEL DIMENSION**

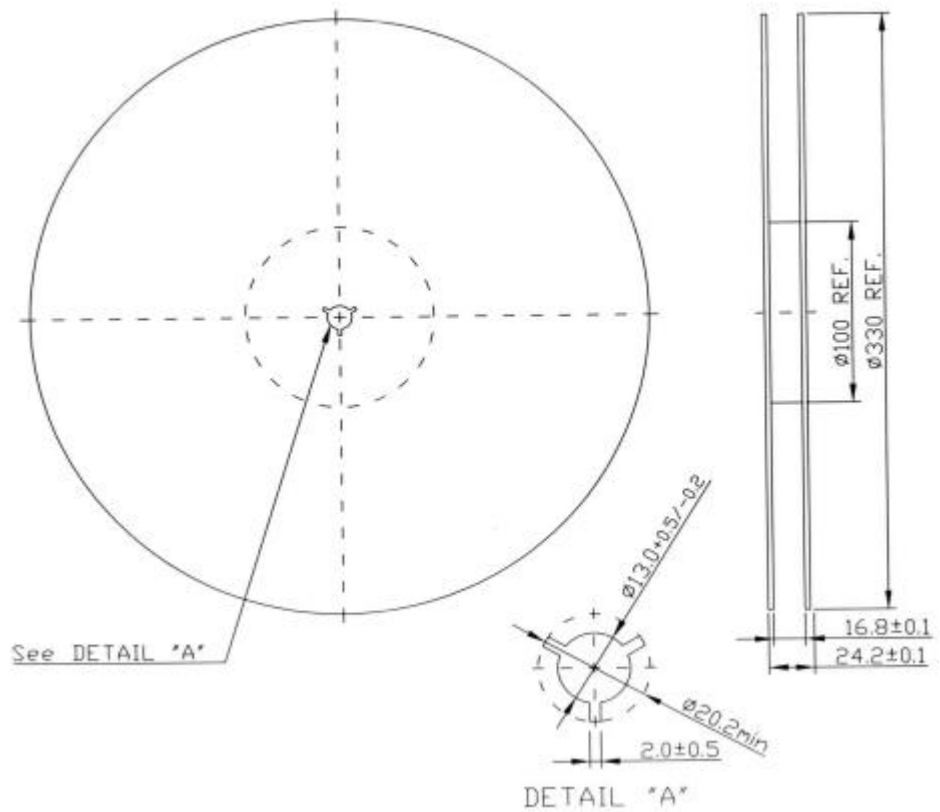

**2. TAPE DIMENSION**

