

SAW Resonator 423.22MHz

Model: TC0149E

Part No: MA07889

REV. NO.: 1

A. FEATURES:

1. 1-Port Resonator.

B. MAXIMUM RATING:

1. Power Dissipation: 0 dBm.
2. DC voltage: 12 V.
3. Storage Temperature: -40 °C to 85 °C.
4. Operating Temperature:-40 °C to 85 °C

C. ELECTRICAL CHARACTERISTICS:

| Characteristic | Units | Minimum | Typical | Maximum |
|-------------------------|---------|--------------|---------|---------|
| Center frequency Fr | MHz | 423.145 | 423.22 | 423.295 |
| Insertion Loss IL | dB | - | 1.2 | 2.5 |
| Unloaded Quality factor | | - | 15000 | - |
| Ageing of Fc | ppm | - | - | 10/year |
| Equivalent Elements | | | | |
| Motional capacitance C1 | fF | - | 2.2 | - |
| Motional inductance L1 | µH | - | 64.5 | - |
| Motional resistance R1 | Ohm | - | 13 | 31 |
| Parallel capacitance Co | pF | - | 3.8 | - |
| Temp.coeff. | ppm/c*2 | - | 0.032 | - |
| Turnover To | deg.C | 25 | - | 55 |
| Package size | | SMD5X5X1.7mm | | |

SAW Resonator 423.22MHz
Part No: MA07889

Model: TC0149E
REV. NO.: 1

D. OUTLINE DRAWING:

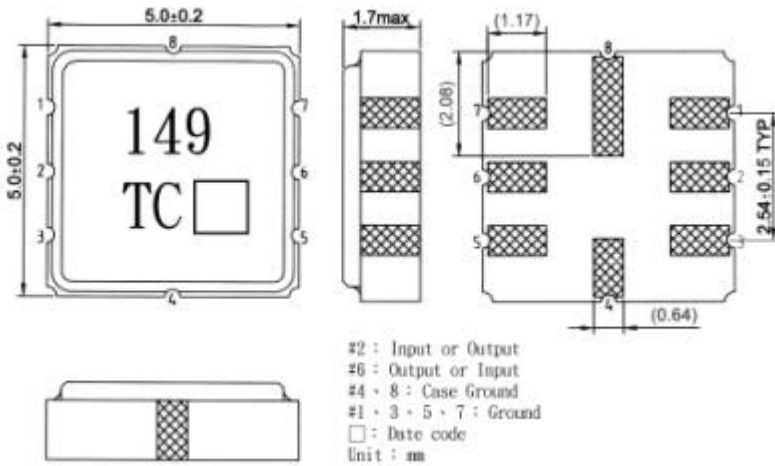

D. EQUIVALENT CIRCUIT:

One-Port Resonator:

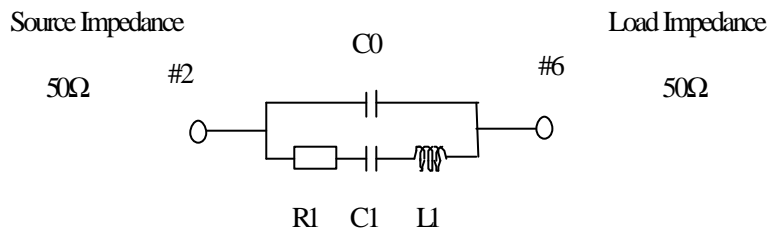

SAW Resonator 423.22MHz
Part No: MA07889

Model: TC0149E
REV. NO.: 1

F. FREQUENCY CHARACTERISTICS:

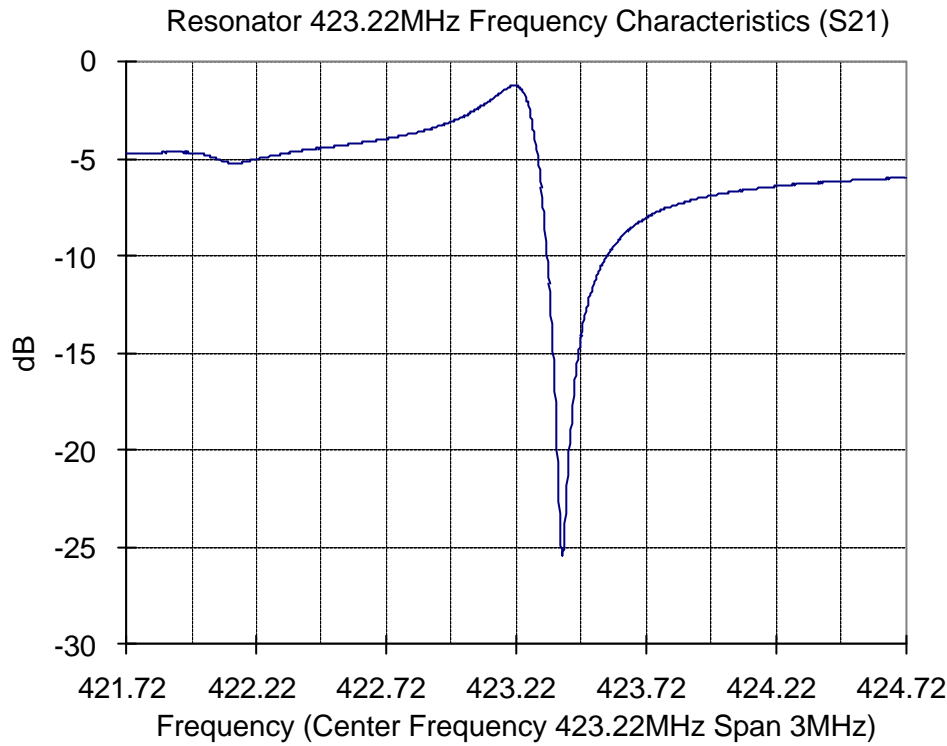

G. TEST CIRCUIT:

Network analyzer

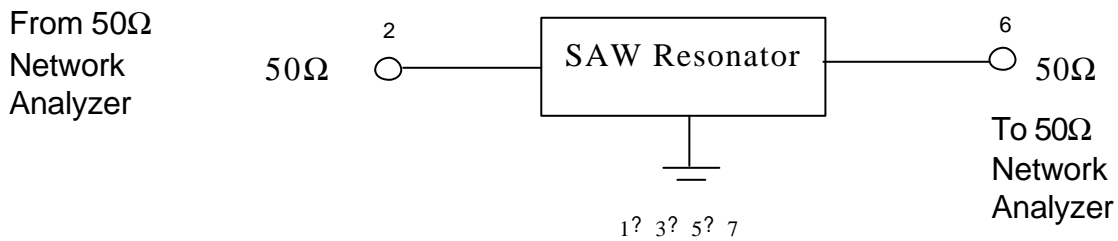

SAW Resonator 423.22MHz

Model: TC0149E

Part No: MA07889

REV. NO.: 1

H. PACKING:

1. REEL DIMENSION

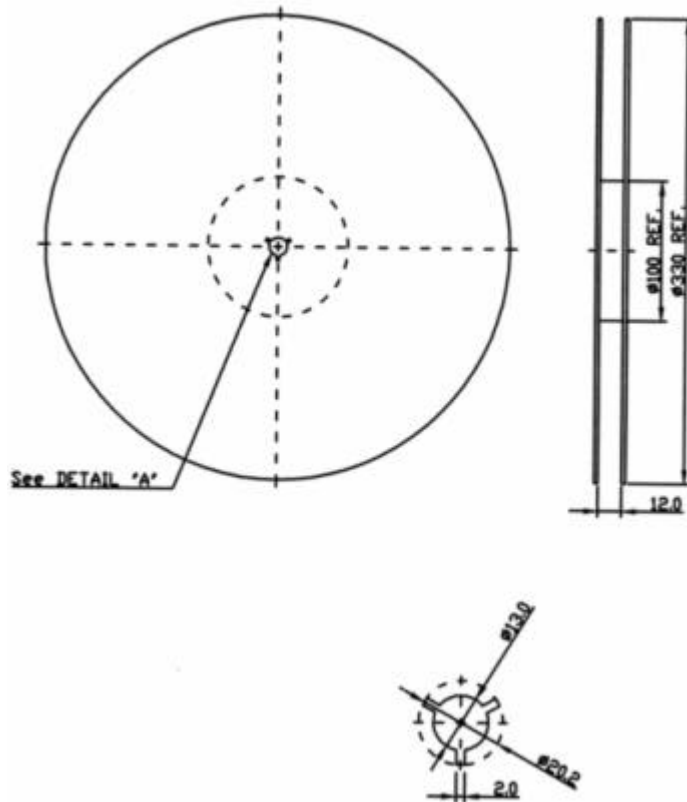

2. TAPE DIMENSION

