

SAW Filter 2441.8MHz for Bluetooth
Part No: MA05253

Model: TA0223A
Rev No: 2

A. MAXIMUM RATING:

1. Input Power Level: 10dBm
2. DC voltage: 0V
3. Operating Temperature: -40°C to +85°C
4. Storage Temperature: -40°C to +85°C

B. ELECTRICAL CHARACTERISTICS:

Item	Min.	Typ.	Max.
Center frequency Fc (dB)	-	2441.8	-
Insertion loss (2400 ~ 2483.5MHz) IL (dB)	-	2.1	5.0
Amplitude ripple (2400 ~ 2483.5MHz) (dB)	-	0.9	3.0
Attenuation (Reference level from 0dB)			
DC ~ 1700MHz (dB)	20.0	29.0	-
1700 ~ 2200MHz (dB)	25.0	30.0	-
2700 ~ 3100MHz (dB)	30.0	40.0	-
3100 ~ 4000MHz (dB)	20.0	29.0	-
4000 ~ 5000MHz (dB)	10.0	20.0	-
VSWR (2400 ~ 2483.5MHz)	-	1.7	2.6
Source impedance Z _S (Ω)	-	50	-
Load impedance Z _L (Ω)	-	50	-

Note1: The standard definitions is in JIS C 6703

SAW Filter 2441.8MHz for Bluetooth
Part No: MA05253

Model: TA0223A
Rev No: 2

C. MEASUREMENT CIRCUIT:

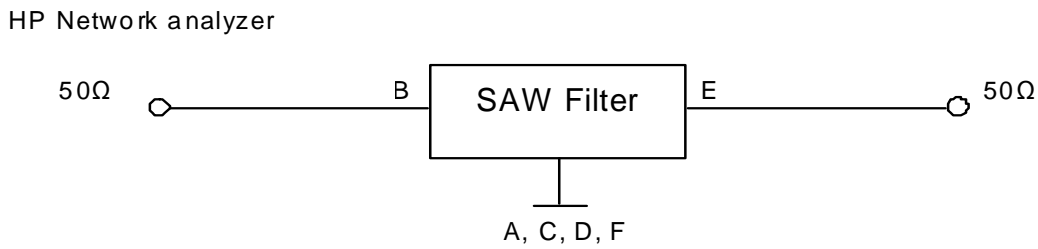

D. OUTLINE DRAWING:

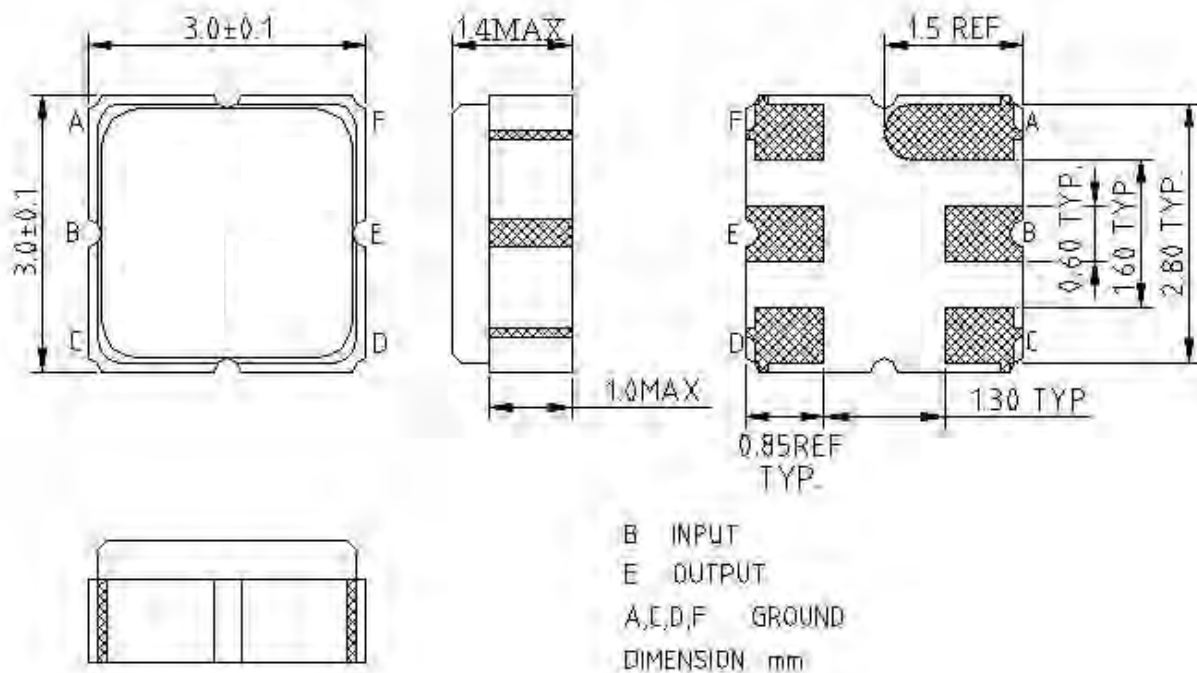

SAW Filter 2441.8MHz for Bluetooth
Part No: MA05253

Model: TA0223A
Rev No: 2

E. FREQUENCY CHARACTERISTICS:

Transfer function

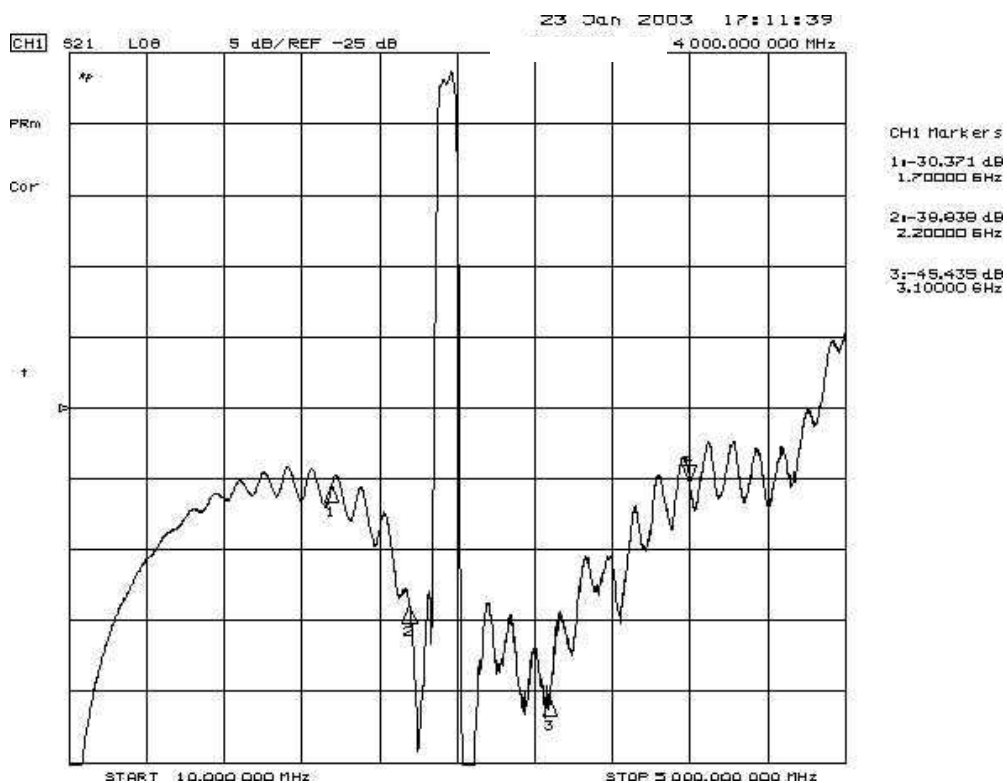
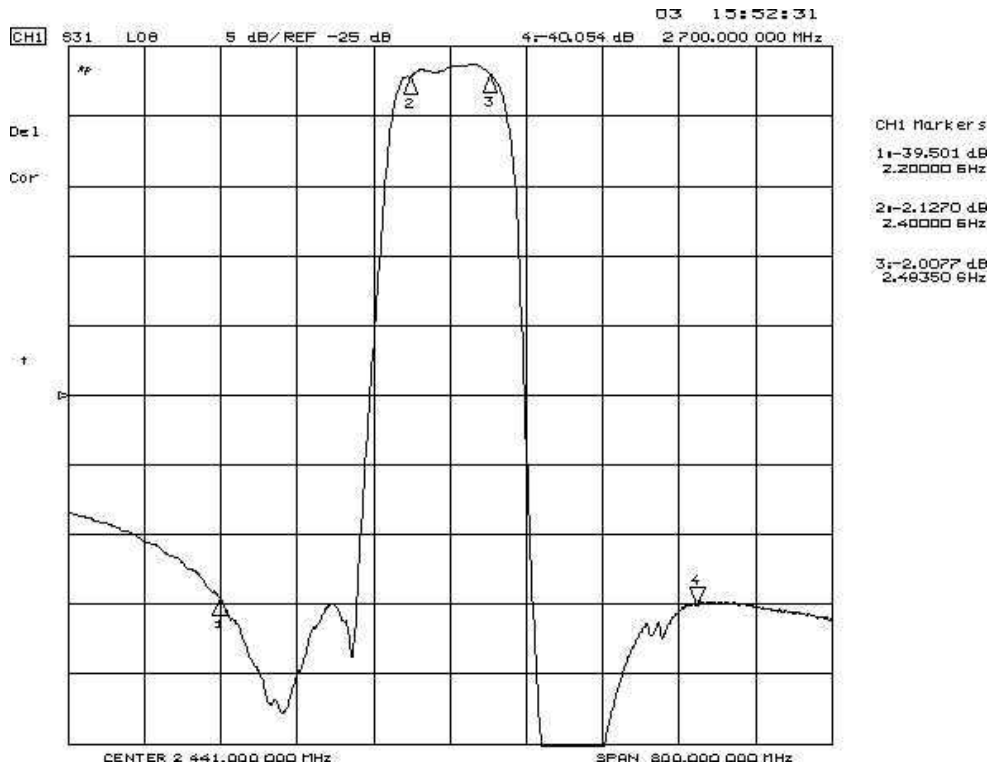

SAW Filter 2441.8MHz for Bluetooth
Part No: MA05253

Model: TA0223A
Rev No: 2

Reflections Functions

S11 VSWR

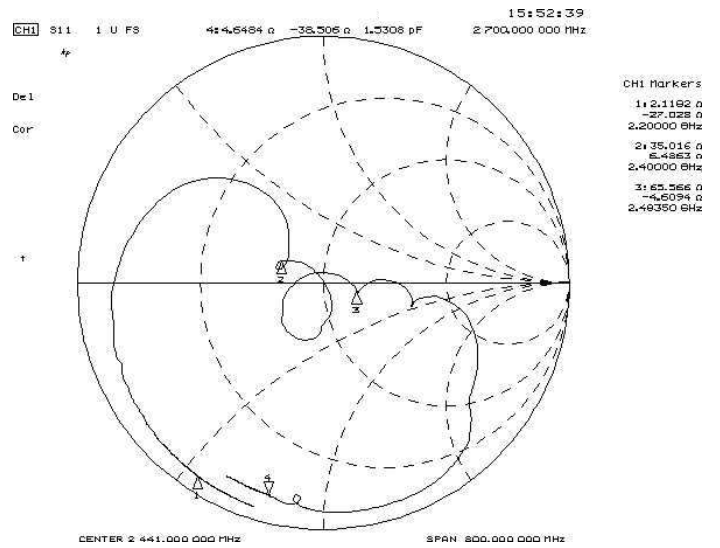
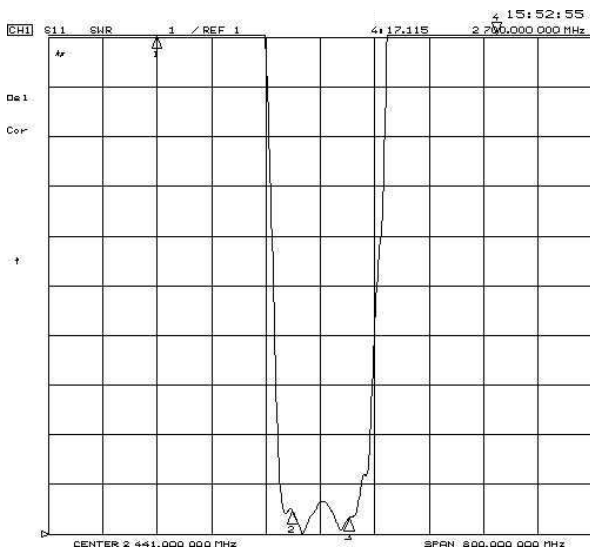

S22 VSWR

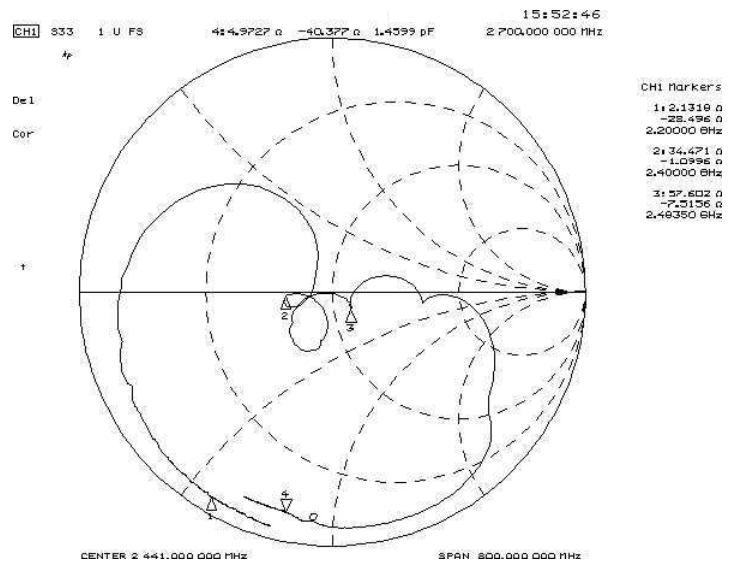
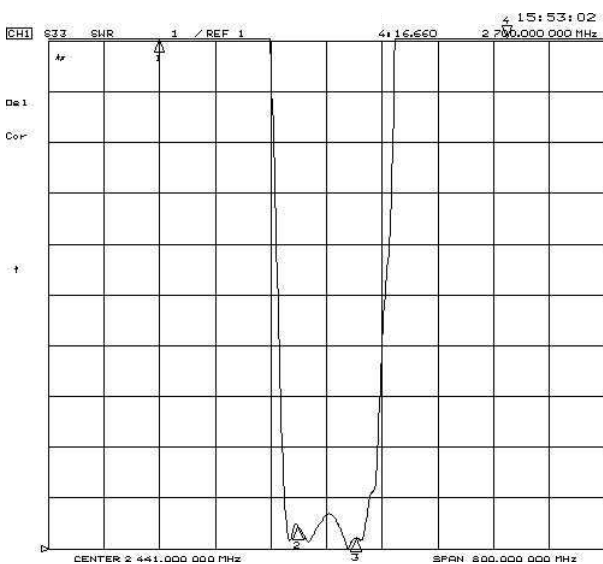

SAW Filter 2441.8MHz for Bluetooth
Part No: MA05253

Model: TA0223A
Rev No: 2

F. PACKING:

1. REEL DIMENSION

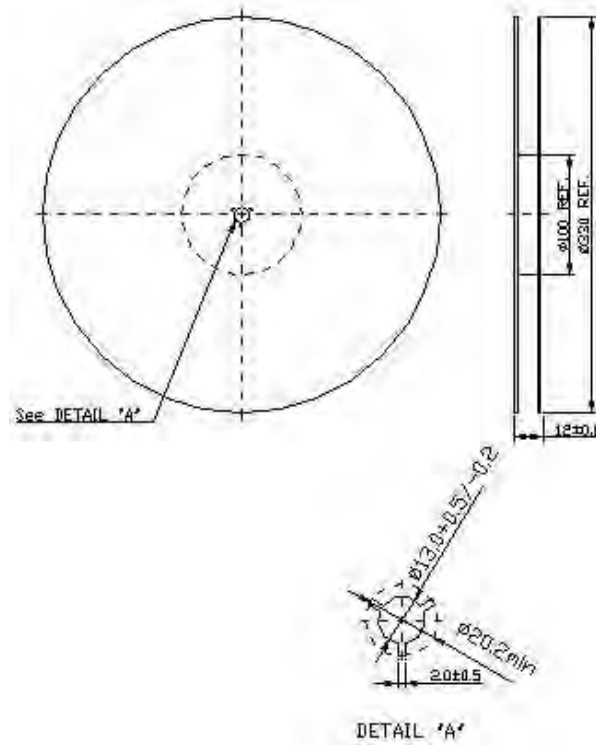

2. TAPE DIMENSION

